

阀门选型指南

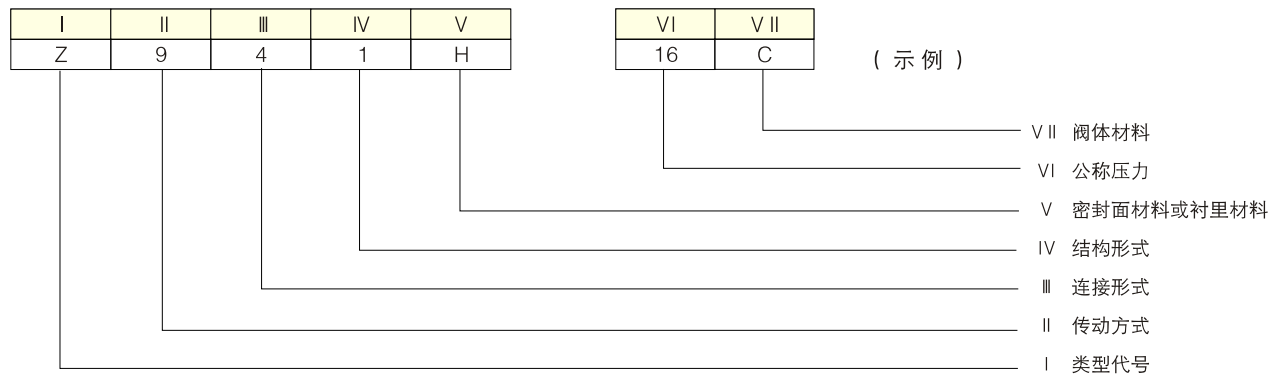

代号	0	1	2	3	4	5	6	7	8	9
II - 传动方式	电磁动	电磁-液动	电-液动	蜗轮	正齿轮	锥齿轮	气动	液动	气-液动	电动
III - 连接形式		内螺纹	外螺纹		法兰		焊接	对夹	卡箍	卡套
I - 类型代号	VI - 结构形式									
闸阀	Z	明杆				暗杆				-
		楔式		平形式		楔式		平形式		
截止阀	J	-	刚性		刚性		平衡		-	-
			弹性闸阀	单闸板	双闸板	单闸板	双闸板	单闸板		
节流阀	L	-	直通式	Z型式	三通式	角式	直流式	直通式	直角式	-
柱塞阀	U	-								
球阀	Q	半球直通	浮动球			固定式				
			直通式	三通式Y形	-	三通式	四通式	直通式	三通式	
蝶阀	D	非密封型三偏心	密封型			非密封型				
			中线式	单偏心	双偏心	连杆机构	三偏心	中线式	单偏心	双偏心
隔膜阀	G	-	屋脊式	-	截止式	-	直流式	直通式	-	角式Y形
旋塞阀	X	-	填料密封			油密封				
			直通式	T型三通式	四通式	直通式	T型三通式			
止回阀	H	-	升降式		旋启式		多瓣式		回转蝶形	
			直通式	立式	角式	单瓣式	双瓣式	多瓣式	回转蝶形	截止止回
安全阀	A	带散热片全启式	弹簧封闭		弹簧不封闭		弹簧不封闭			
			微启式	全启式	双联微启式	全启式	带控制全启式	微启式	全启式	带扳手
减压阀	Y	-	薄膜式	弹簧薄膜式	活塞式	波纹管式	杠杆式	-	-	-
疏水阀	S	-	浮球式	-	浮桶式	膨胀式	钟形浮子式	膜盒式	双金属片式	脉冲式
排污阀	P	-	液面连续排放		液面间断排放				热动力式	
			直通式	角式	直通式	直通式	角式	浮动闸板型		
VI 公称压力	公称通径的数值用10倍的兆 (MPa) 数表示; 用于电站工业的阀门, 当介质最高温度超过425°C时, 标注工作压力。									

V - 阀座密封面或衬里材料	代号	V - 阀座材料	代号
巴氏合金	B	尼龙塑料	N
搪瓷	C	渗硼钢	P
渗氮钢	D	衬铅	Q
氟塑料	F	Mo2Ti系不锈钢	R
陶瓷	G	塑料	S
Cr13系不锈钢	H	铜合金	T
衬胶	J	橡胶	X
蒙乃尔合金	M	硬质合金	Y

VII - 阀体材料	代号	VII - 阀体材料	代号
钛及钛合金	TI	球墨铸铁	Q
碳钢	C	Mo2Ti系不锈钢	R
Cr13系不锈钢	H	塑料	S
铬钼钢	I	铜及铜合金	T
可锻铸铁	K	铬钼钒钢	V
铝合金	L	灰铸铁	Z
18-8系不锈钢	P		

注: 1、PN≤1.6MPa的灰铸铁阀体和PN≥2.5MPa的碳素钢阀体材料可省略本代号;
2、CF3、CF8、CF3M、CF8M等材料牌号可直接标注在阀体上。

HOW TO ORDER

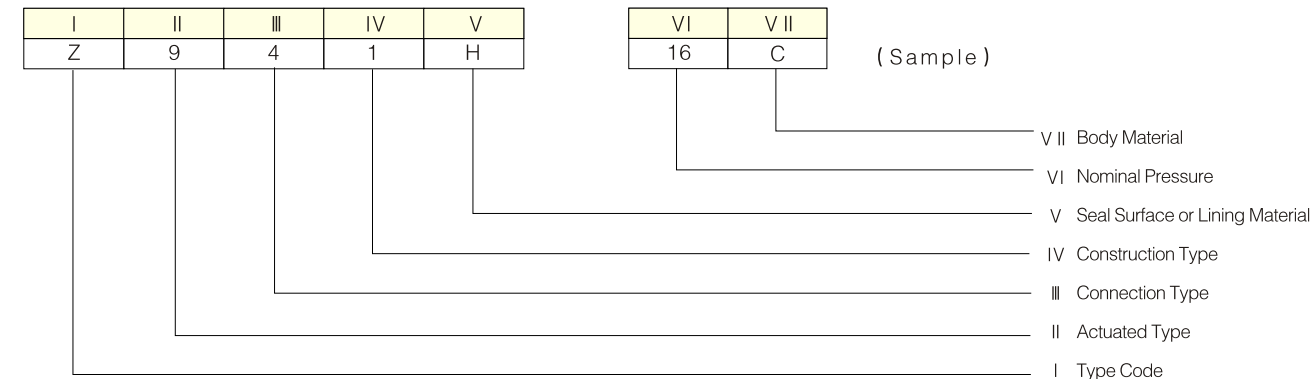

Ccode	0	1	2	3	4	5	6	7	8	9
II - Actuated Type	Electro magnetic	Electro-hydraulic	Electrical-hydraulic	Gear	Spur gear	Angle gear	Pneumatic	Hydraulic	Pneumatic-hydraulic	Electrical
III - Connection	-	Inside screw	Outside screw	-	Flange	-	Welding	Wafer	Union ring	Compression joint
I - Type Code	IV - Construction Type									
Gate Valve	Z	Rising stem				Non-rising stem				-
		Wedge type		Parallel type		Wedge type		Parallel type		
Globe Valve	J	-	Rigid disc				Rigid disc			
			Flexible	Single	Double	Single	Double	Single	Double	Single
Throttle Valve	L	-	Through way	Z-Type	Tee	Angled	Straight flow	Balance type		-
Piston Valves	U	-	Floating type				Trunnion-mounted			
			Half-ball through way	Through way	Y-Pattern Tee	-	Tee	Four-way	through way	Tee
Butterfly Valve	D	Non-seal tri-eccentric	Seal type				Non-seal type			
			Center line-type	Single-eccentric	Bi-eccentric	Link mechanism	Tri-eccentric	Center line-type	Bi-eccentric	Link mechanism
Diaphragm Valve	G	-	Weir type	-	Globe type	-	Y-pattern	Through way type	-	Y-pattern angle type
Plug Valve	X	-	Packing seal				Lubricate seal			
			Through way type	T-pattern Tee	Four-way type	-	Through way type	Tee T-type		
Check Valve	H	-	Lift type			Swing type			Rotary type butterfly	
			Th.way	Vertical type	Angle type	Single-plate	Double disc	Multi-disc	Globe check	
Safety Valve	A	Full lift with cooling fin	Spring seal type		Spring unseal	Spring seal	Lever	Spring unseal		Pulse
			Low lift	Full lift	Spanner type			Full lift with control	Low lift	
Reducing Valve	Y	-	Diaphragm	Spring diaphragm	Piston	Bellows	Lever	-	-	-
Trap Valve	S	-	Ball float	-	Open bucket	Expansion	Inverted bucket type	Membrane-box	Bimetal elements	Pulse
Waste Valve	P	-	Continuous Discharge		Discontinuous discharge					
			Through way type	Angle type	Straight flow type	Through way type	Angle type	Float gate disc type		
VI - Nominal Pressure	The data of nominal diameter is express as ten times Mpa valve; It will mark working pressure when medium temperature over 42°C And be used in power station									

V-seat seal surface or lining material	Code	V-seat seal surface or lining material	Code
Babbitt metal	B	Nylon plastic	N
Enamel	C	Boronizing steel	P
Nitrided steel	D	Lead Lining	Q
Fluoroplastics	F	Mo2Ti series SS	R
Ceramic metal	G	Plastic	S
Cr13 series SS	H	Copper alloy	T
Rubber lined	J	Rubber	X
Monel metal	M	Stellite	Y

Remark: 1、Code W is express material of seat surface that direct machining from body.
2、Except diaphragm valve, it mark with low hardness material code when seal surface material is different.

VII - Body material	Code	VII - Body material	Code
Titanium & titanium alloy	TI	Spheroidal cast iron	Q
Carbon steel	C	Mo2Ti series SS	R
Cr13 series SS	H	Plastic	S
Cr-Mo steel	I	Copper & Copper Alloy	T
Malleable iron	K	Cr-Mo-V steel	V
Aluminum alloy	L	Gray cast Iron	Z
18-8series SS	P		

Remark: 1、Omit the code if body material is gray cast iron body when PN≤1.6MPa and is carbon steel body when PN≥2.5MPa.
2、CF3、CF8、CF3M、CF8M etc material code can direct mark on body.

TIANJIN K.R.S VALVES CO., LTD.

LEAD VALVE SCIENCE AND TECHNOLOGY 引领阀门科技



蝶阀系列 Butterfly Valves Series



蝶阀型号编制说明 The explanation of the model numbering system of butterfly valve

卡尔斯 引领阀门科技
LEAD VALVE SCIENCE AND TECHNOLOGY
TIANJIN K.R.S VALVES CO., LTD.



阀杆密封圈

The valve pole seals up the circle.

控制装置法兰: 可以配用手柄蜗轮蜗杆传动、电动和气动等各种控制装置。
The control device flange: various control devices such as manua and tubine worm-dive, motor-driven hydraulic pressure and pneumatic can be joined in marriage.

阀杆密封: 密封座的阀杆孔与阀杆配合紧密并牢固地镶嵌在阀座内、具有极好的密封性能。阀杆周围无泄漏现象。
The valve board seals up: the valve pole hole of gasket possesses the fibulas close function with cooperating closely securely to inlay the valve inside the seat and the valve pole leaks the appearance in week.

酚醛靠背阀座: 具有不脱落、抗拉、防泄漏更替方便等特点。
The phenolic aldehyde back valve seat: possesses not to drop and the anti-pulis, and the characteristics such as guarding against leaking and changes convenient etc.

高精度阀板: 阀板经抛光处理与阀座配合精度高、具有良好的密封性, 阀杆处无泄漏现象。
The split-hair accuracy valve board: the valve board cooperates the precision height through polishing the processing valve stea, and possessing the nature well seals that the valve pole place does not have the appearance of leaks.

阀板外形尺寸精确, 截流后密封性好, 阀板与阀座间无干涉现象, 从而保证了操作力矩小、阀座使用寿命长等特点。
The valve board appearance size is accurate, and close nature is good after damming a river, does not have the interference between valve board and valve seat at present, thus pledged that operation moment of force is small, long class of characteristic in valve service life.

阀杆密封不易变形, 从而避免了通常的阀杆泄漏现象。
The valve pole seals up easily not becoming deformed, thus the valve pole leakage appearance avoided usually.

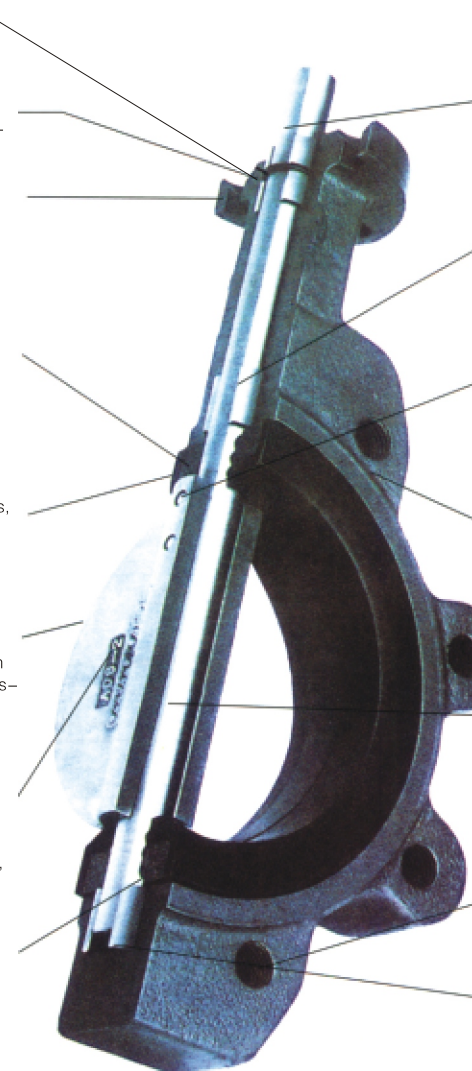

连接键精度高: 既适用于安装操纵手柄又适用于各种控制装置。
It is big to link key precision high strength: is suitable in installing the control but also being suitable in the various contrl devices.

润滑青铜轴套: 既起支承阀杆的作用又便于将阀杆脱离阀座。
The bronze axle sleeve lubricate: not only takes the effect of the valve supporting pole but also is easy to separate oneself from the valve pole valve seat.

锥形销: 精度高, 将阀杆与阀板连接在一起后具有防振脱特点, 并且易于更换。
The awl forelock: the precision is high, and connection together after possesses guarding against shakes sheds characteristic with the valve beard valve pole, and seasy to changing.

具有对夹和单夹型阀体, 阀体上衬有各种材质的阀座, 包括聚四氟乙烯。
Possessing to wafer and single wafer clamp mould valve body, the valve is lined qualitative valves of the various materials seats on the body, and incudesthe polytetrafluoroethylene.

整体阀杆结构: 整体性好, 便于控制阀板启闭。
The entire valve pole struture: entire nature is good, and being easy to the control valve board is poened and close.

对中性好、安装方便省时。
Good to the middle function: it is convenience and save time when installing.

轴向上推轴承: 防止阀杆超载。
The axial thrust bearing: The valve pole overload is prevented.

蝶阀型号编制说明 The explanation of the model numbering system of butterfly valve

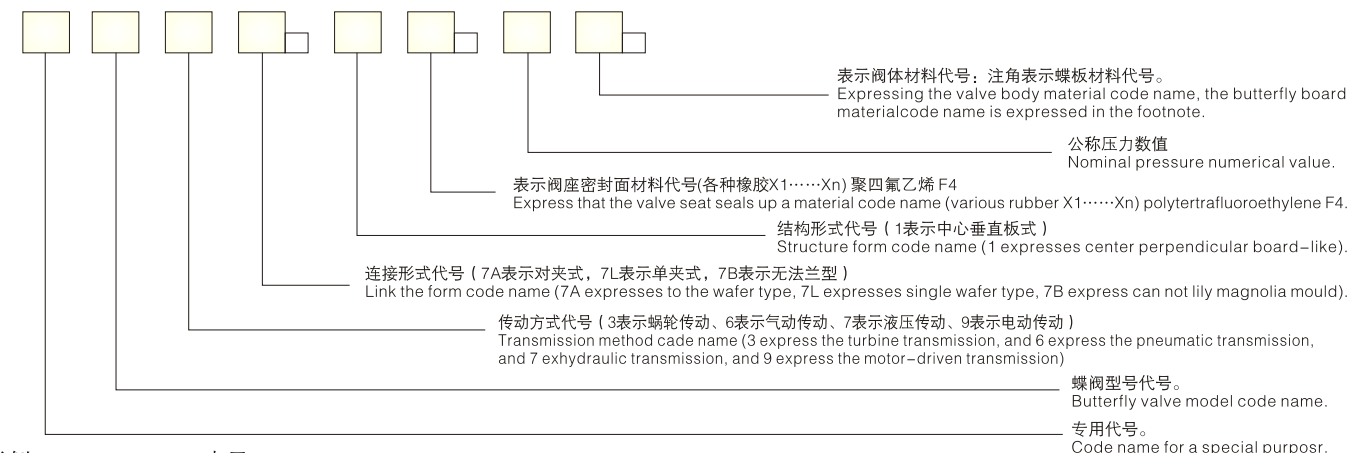

举例D37A1X5-10ZB1表示:

蜗轮蜗杆传动方式的中线对夹式蝶阀(A型), 板式结构为中心垂直板式, 阀座密封材料为丁晴橡胶, 阀门公称压力为1.0MPa, 阀体材料为灰铸铁, 阀板材料为电镀球墨铸铁。

The D37A1X5-10ZB1 giving an example expresses that htewafer worm gear worm-actuated method is to midline wafer butterfly valve (A's mould), and the boardlike structure is for the center is board-like, and the valve seat sealing material is for NBR, and valve nominal pressure is grey cast iron for 1.0MPa. 's valve body material, and valve board expect for electroplating mark China ink iron casting.

采用标准 Accepted standard

产品名称 Name	产品执行标准名称 The Product carries out the standard name	执行标准编号 Carry out the standard serial number	结论 Conclusion
蝶阀 Butterfly valve	对夹连接防腐蝶阀 Grip the butterfly gate linking antisopsis face to face	Q/12 NK3321-2001	现行 Carry out now
蝶阀 Butterfly valve	碳素结构钢 Carbon steal	GB/T700-1988	现行 Carry out now
蝶阀 Butterfly valve	形状和位置公差为注公差值 The form and the location common difference are to annotate common difference value	GB1184-1996	现行 Carry out now
蝶阀 Butterfly valve	不锈钢棒 Stainless Steel	GB1220-1992	现行 Carry out now
蝶阀 Butterfly valve	通用阀门标志 The valve being applied or used universally indicated	GB/T12220-1989	现行 Carry out now
蝶阀 Butterfly valve	部分回转阀门驱动装置的连接 Part gyration valve driving device connection	GB/T12223-1989	现行 Carry out now
蝶阀 Butterfly valve	通用阀门灰铸铁件技术条件 Valve grey cast iron document requirement being applied or used universally	GB/T12226-1989	现行 Carry out now
蝶阀 Butterfly valve	通用阀门球墨铸铁件技术条件 Valve SG iron document requirement being applied or used universally	GB/T12227-1989	现行 Carry out now
蝶阀 Butterfly valve	通用阀门压力试验 Pressure test the valve being applied or used universally	GB/T13927-1992	现行 Carry out now
蝶阀 Butterfly valve	通用阀门供货要求 The valve supply of material being applied or used universally demanes	JB/T7928-1999	现行 Carry out now
蝶阀 Butterfly valve	模塑用聚四氟乙烯树脂 Fumble along mould use PTFE	HG/T2902-1997	现行 Carry out now

阀门金属材质、非金属材料、耐腐蚀耐温推荐表 Valve metal material quality, nonmetalloid material quality, corrosion prevention proof warm up recommend table

材质 Material	适用温度 Sutable temperature	介质类型及适用程度 The type reaches medium applying to degree												突出特点 Be outstanding Feateres		
		淡水 Fresh water	海水 sea-water	盐类 Salt	强碱 Strong Alkali	弱碱 Weak Alkali	强酸 strong Acid	弱酸 Weak Acid	天然气 Natural Gas	醇类 Alcohol	空气 Air	蒸汽 Steam	油类 Oil		食品 Food	
阀座 Valve Seat	丁晴橡胶(NBR)X5	-23°C~93°C	A	A	A	B	A	D	B	A	C	A	D	A	B	耐油 Be able to bear Oil
	乙丙橡胶(EPDM)X3	-46°C~135°C	A	A	A	A	A	C	A	B	B	A	A	C	A	耐老化 Weather resistance
	耐热乙丙橡胶X9	-46°C~150°C	A	A	A	A	A	C	A	B	B	A	A	C	A	耐热、耐老化 Heat resisting Weather resistance
	天然橡胶(NR)X1	-20°C~85°C	A	A	A	A	A	C	B	D	C	A	B	B	B	高弹性 High bomb melt
	氯丁橡胶(CR)X4	-29°C~99°C	A	A	B	B	A	D	D	D	C	A	D	D	B	耐磨、耐老化 Worm, Weather resistance
	硅橡胶(SI)	-55°C~180°C	A	A	B	D	B	D	B	A	B	A	A	C	C	耐高温 High temperature
	氟橡胶(FPM)X7	-23°C~200°C	A	A	A	C	A	C	A	A	C	A	A	A	A	耐腐蚀、耐高温 Corrosion prevention, High temperature
	聚四氟乙烯(PTFE)F4	-20°C~180°C	A	A	A	A	A	A	A	A	A	A	A	A	A	耐所有化学介质腐蚀 Proof possession chemical mediator erode
蝶阀 Board	球铁电镀 Plate with Ball Iron Electricity	-30°C~350°C	B	D	C	D	C	D	C	B	A	B	A	A	C	耐热 Heat resisting
	碳钢聚酰胺覆层(PA)	-30°C~100°C	A	A	A	A	A	D	A	A	C	A	A	A	A	耐腐蚀、耐碱性能佳 Corrosion prevention, alkaline resistance properties beautiful
	碳钢氯化聚酰胺覆层(PCR)	-30°C~140°C	A	A	A	A	A	A	A	A	A	A	C	A	A	耐腐蚀、耐碱性能佳 Corrosion prevention, alkaline resistance properties beautiful
	聚四氟乙烯(PTFE)	-20°C~180°C	A	A	A	A	A	A	A	A	A	A	A	A	A	耐所有化学介质腐蚀 Proof possession chemical mediator erode
	氟塑碳钢覆层(PFA)	-20°C~180°C	A	A	A	A	A	B	A	A	A	A	A	A	A	耐腐蚀、耐高温 Corrosion prevention, High temperature
	不锈钢 Stainless Steel	-252°C~316°C	A	C	C	C	B	C	B	A	A	A	A	A	A	耐腐蚀、耐高温 Corrosion prevention, High temperature
	铝青铜 Aluminium Bronze	-212°C~232°C	A	C	C	D	C	D	C	A	A	A	A	A	C	耐热、耐一般腐蚀 Heat resisting proof general corrosion
钛金属 Titanium Metal	-196°C~550°C	A	A	A	A	A	C	B	A	A	A	A	A	B	耐腐蚀、耐高温 Corrosion prevention, High temperature	



A: 非常适用 B: 适用 C: 有限适用 D: 不适用
A: Very Suitable B: Suitable C: Limited Suitable D: No Suitable

对夹式蝶阀 Wafer Butterfly Valve

性能规范 Technical Data

公称通径 DN(mm) Nominal Diameter	50(2")~1000(40")	50(2")~800(32")
公称压力 PN(MPa) Nominal Pressore	1.0	1.6
试验压力(MPa) Testing Pressure	壳体 Shell	2.4
	密封 Sealing	1.76
适用温度°C Working temperature	-15~+150	
适用介质 Suitable medium	淡水、污水、海水、空气、蒸气、食品、药品、各种油类、酸类、碱类、盐类等 Fresh water, Sewage, Sea Water, Air, Steam, Food, Medicine, Oils, Acids, etc.	

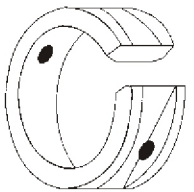
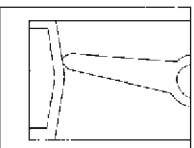
密封特点比较 Seal Construction & Features

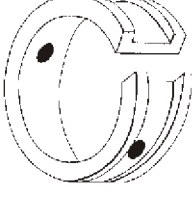
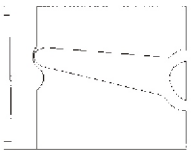
密封特点比较 Seal Construction & Features	"A"、"L"型结构 Type "A", "L" Construction	传统结构 Traditional Constructon
 <p>阀板经过精加工处理，外径与板面尺寸的精度高，允差范围小。板缘是经过抛光处理的半球面，可减小操作力矩。</p> <p>The disc is precision machined to close tolerances on the O.D. and flats. Sealing edge is a polished half bait for torque control.</p>	 <p>具有酚醛靠背的橡胶密封垫整体支承性好、稳定牢固，既保证了支承力矩又不易变形。</p> <p>By bonding the elastomer to a phenolic backing ring complete support and stability of the seat is assured. This guarantees positive control of seating torque while eliminating seat distortion.</p>	 <p>阀座与阀板的结构先进新颖，密封性能好，阀座力矩小。结构可以避免阀座隆起和撕裂现象，延长阀座使用寿命。</p> <p>The modern seat and disc design insures positive sealing while maintaining low seating torque. The design extends seat life by eliminating any bunching or tearing.</p>
 <p>传统的阀板是铸造成形，磨削加工而成的，无法保证精确的尺寸。</p> <p>The conventional disc is a casting which has been sand-cast to remove rough areas. Precise dimensions are not maintained.</p>	 <p>无加强结构的阀座在安装和关闭的过程中容易变形造成泄漏，增加启闭扭矩弊端。</p> <p>The conventional non-reinforced seat design is subject to distortion during installation and closing. A distorted seat contributes to shaft leakage and high opening/closing torque.</p>	 <p>传统结构是靠阀座隆起来实现密封的，缩短了使用寿命，增加了维修费用和检修时间。</p> <p>The conventional design relies on distortion and bunching of the seat to achieve a bubble-tight shut-off. Seat life is decreased, causing higher maintenance costs and increased downtime.</p>
<p>阀门具有降低控制装置造价的特点：</p> <ul style="list-style-type: none"> ● 阀杆轴与阀板缘加工精度高， ● 组合式阀座防止变形，允差范围小。 ● 有效的阀杆密封 ● 阀座的膨胀的潜在影响小， ● 结构合理、扭矩限定在适当的范围内。 <ul style="list-style-type: none"> ● Precision machined disc edge and shaft flats ● Bonded distortion proof seat close tolerances ● Positive shaft seals ● Low potential of seat swell ● Controlled torque by design superiority. 	<p>增加控制装置造价的因素：</p> <ul style="list-style-type: none"> ● 阀板尺寸精度无法保证； ● 安装与工作时的阀座变形； ● 阀座寿命短； ● 隆起与膨胀造成扭矩增大。 <ul style="list-style-type: none"> ● Non-precision disc dimensions ● Seat distorts during installation and operation ● Shorter seat life. ● Higher torque due to bunching and potential swelling. 	

特点 Features

- 1、小型轻便，容易拆装及维修，并可在任意位置安装。
- 2、结构简单，紧凑，90°回转启闭迅速。
- 3、操作扭矩小，省力轻巧。
- 4、流量特性趋于直线，调节性能好。
- 5、启闭试验次数多达数万次，寿命长。
- 6、达到完全密封，气体试验泄漏为零。
- 7、选择不同零部件材质，可适用多种介质。



- 1、Small in size and light in weight. Easy installation and maintenance. It can be mounted wherever needed.
- 2、Simple and compact construction, quick 90 degrees on-off operation.
- 3、Minimized operating torque, energy saving.
- 4、Flow curve tends to straightline. Excellent regulation performance.
- 5、Long service life. Standing the test of tens of thousands opening/closing operations.
- 6、Bubbles-tight sealing with no leakage under the pressure test.
- 7、Wide selection of materials applicable for various medium.

主要零部件材料 Material of Main Parts

阀体 Body		阀板 Disc		转轴 Stem		衬套 Bushing		阀座 Seat		适用温度℃ Working Temp
材料名称 Name	代号 Code	材料名称 Name	代号 Code	材料名称 Name	材料名称 Name	材料名称 Name	代号 Code			
灰铸铁 Cast Iron	Z	电镀球墨铸铁 Plated Ductile Iron	B1			天然胶 NR	X1	-20~+85℃		
球墨铸铁 Ductile Iron	Q	铝青铜 Aluminum Bronze	B2			海帕伦 Hypalon	X2	-23~+121℃		
铝青铜 Aluminum Bronze	T	ZG1Cr18Ni9Ti 不锈钢 Stainless Steel	B3	不锈钢 Stainless Steel	润滑青铜 Lubricated Bronze	氯丁橡胶 Neoprene	X4	-7~+93℃		
ZG1Cr18Ni9Ti 不锈钢 Stainless Steel	P	钛钢 Titanium Steel	B4	碳钢 Carbon Steel	聚四氟乙烯 PTFE	丁腈橡胶 NBR	X5	-23~+100℃		
CF8M 不锈钢 Stainless Steel	R	CF8M 不锈钢 Stainless Steel	B5			耐磨橡胶 Wear-resistant Rubber	X6	-10~+100℃		
碳钢 Carbon Steel	C	碳钢 Carbon Steel	B6			氟橡胶 VITON	X7	-23~+200℃		
		CF8M 不锈钢 Stainless Steel	B7			耐热乙丙橡胶 Heat-resistant Rubber	X9	-23~+135℃		
						聚四氟乙烯 PTFE	F4	+10~150℃		

"A"型蝶阀外型尺寸，连接尺寸和重量
Overall & Connection Dimensions & Weight of Type "A" Butterfly Valve

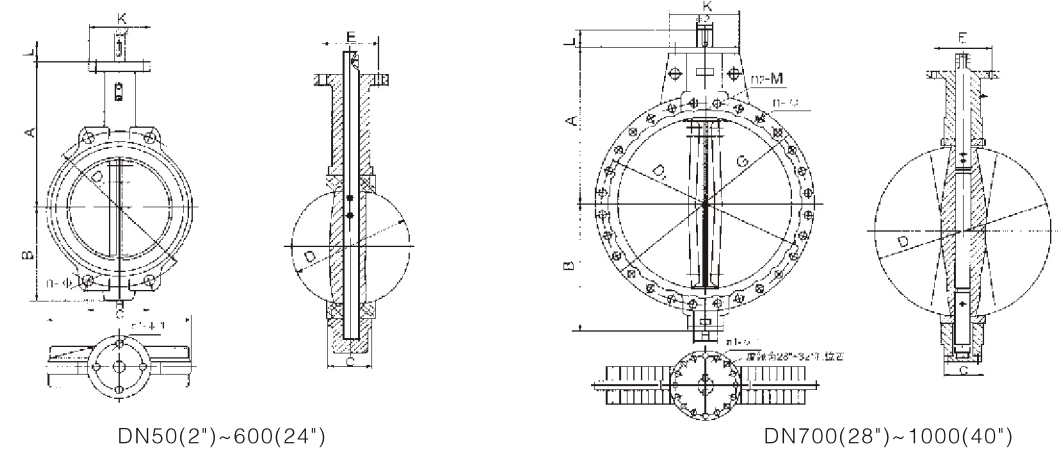

公称通径 Nominal diameter DN		尺寸 Size (mm)													重量 Weight (kg)		
(mm)	(inch)	A	B	C	D	L	H	D1	n-φ	K	E	n1-φ1	φ2	G		n2-M	
		D7A1/37A1/67A1/97A1X-1.0/1.6															
50	2"	161	80	42	52.9	32	84.84	120	4-23	77	57.15	4-6.7	12.6	118	-	2.5	
65	2.5"	175	89	44.7	64.5	32	96.2	136.2	4-26.5	77	57.15	4-6.7	12.6	137	-	3.2	
80	3"	181	95	45.2	78.8	32	61.23	160	8-18	77	57.15	4-6.7	12.6	143	-	3.6	
100	4"	200	114	52.1	104	32	70.80	185	4-24.5	92	69.85	4-10.3	15.77	156	-	4.9	
125	5"	213	127	54.4	123.3	32	82.28	215	4-23	92	69.85	4-10.3	18.92	190	-	7	
150	6"	226	139	55.8	155.6	32	91.08	238	4-25	92	69.85	4-10.3	18.92	212	-	7.8	
200	8"	260	175	60.6	202.5	45	112.89 76.35	295	4-25 4-23	115	88.9	4-14.3	22.1	268	-	13.2	
250	10"	292	203	65.6	250.5	45	92.40	357	4-29	115	88.9	4-14.3	28.45	325	-	19.2	
300	12"	337	242	76.9	301.6	45	105.34	407	4-29	140	107.95	4-14.3	31.6	403	-	32.5	
350	14"	368	267	76.5	333.3	45	91.11	467	4-30	140	107.95	4-14.3	31.6	436	-	41.3	
400	16"	400	309	86.5	389.6		51.2 72	100.47 102.42	515 525	4-26 4-30	197	158.75	4-20.6	33.15	488	-	61
450	18"	422	328	105.6	440.51		51.2 72	88.39 91.51	565 585	4-26 4-30	197	158.75	4-20.6	38	539	-	79
500	20"	480	361	131.8	491.6		64.2 82	96.99 101.68	620 650	4-26 4-33	197	158.75	4-20.6	41.15	593	-	128
600	24"	562	459	152	592.5		70.2 82	113.68 120.46	725 770	20-30 20-36	276	215.9	4-22.2	50.65	816	-	188
700	26"	624	520	163	695		66 82	109.65	840	24-30 20-36	300	254	8-18		895	4-M33	284
800	32"	672	591	188	794.8		66 82	124	950	24-33 24-39	300	254	8-18		1015	-	368
900	36"	720	656	203	864.7	118	117.57	1050	24-33	300	254	8-18	75	1115	4-M30	713	
1000	40"	800	721	216	965	142	129.89	1160	24-36	300	254	8-18	85	1230	4-M33	864	

注Note:

DN50(2'')~800(32'') "A"型蝶阀分别适用于PN1.0/PN1.6MPa二种压力级，表中每格有两个尺寸的分别表示PN1.0/PN1.6MPa二种压力级连接尺寸。与阀门连接的管法兰连接尺寸参照法兰连接尺寸表。蝶阀上法兰可通用于手动、蜗轮蜗杆传动、电动、气动等。

表中DN50(2'')~500(20'')中D1和D1和n-φ尺寸为蝶阀本身安装定位尺寸，其中DN50(2'')4350(14'')的D1和n-φ尺寸包括GB9112-88、DIN2501(德国)、BS4504(英国)、ISO2084、ISO2531(国际标准)、BS10-E(英国)、ANSI1259(美国)等法兰连接标准。DN400(16'')~500(20'')包括GB9112-88、DIN2501、ISO2084、BS4504法兰连接标准。

DN50(2'')~800(32'')Type "A" butterfly valves are suitable for the pressure of PN1.0MPa and PN1.6MPa grade separately. Two dimensions in one column show the connection dimensions of PN1.0/PN1.6MPa pressure grade. For the connection dimensions of pipe flanges mounted to the valves please refer to the Connection Dimensions of Flanges Table. The upper flanges of the valves are suitable all types of valves fitted with electric, worm gear, manual pneumatic and actuators.

The dimensions D1 and n-φ of DN50(2'')~500(20'') listed in above table show the installation dimensions of butterfly valve of them. The dimensions D1 and n-φ of DN50(2'')~350(14'') contain the standard of GB9112-88, DIN2501(Germany), BS4504(UK)ISO2084, ISO2531(International standard)BS10-E(UK)ANSI1251USA for flange connection and DN400(16'')~500(20'') contain the standard of GB9112-88, DIN2501, ISO2084 and BS4504.

"LT"型蝶阀外型尺寸, 连接尺寸和重量
Overall & Connection Dimensions & Weight of Type "LT" Butterfly Valve

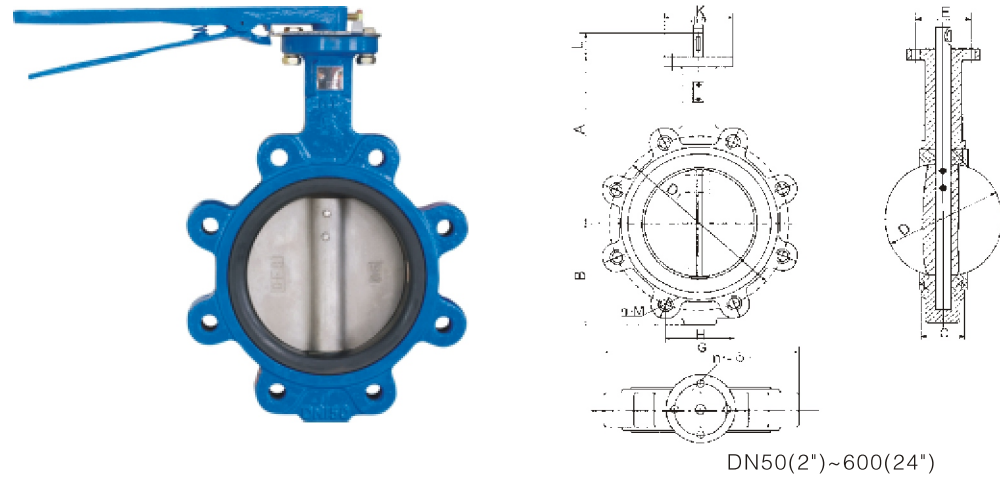

DN50(2")~600(24")

公称通径 Nominal diameter DN		尺寸 Size (mm)													重量 Weight (kg)
(mm)	(inch)	A	B	C	D	L	H	D1	n-φ	K	E	n1-φ1	φ2	G	
		LTD71/371/671/971X-1.0/1.6													
50	2"	161	80	42	52.9	32	88.39	125	4-M16	77	57.15	4-6.7	12.6	118	3.8
65	2.5"	175	89	44.7	64.5	32	102.54	145	4-M16	77	57.15	4-6.7	12.6	137	4.2
80	3"	181	95	45.2	78.8	32	61.23	160	8-M16	77	57.15	4-6.7	12.6	189	4.7
100	4"	200	114	52.1	104	32	68.88	180	8-M16	92	69.85	4-10.3	15.77	206	9.0
125	5"	213	127	54.4	123.3	32	80.36	210	8-M16	92	69.85	4-10.3	18.92	238	10.9
150	6"	226	139	55.8	155.6	32	91.84	240	8-M20	92	69.85	4-10.3	18.92	266	14.2
200	8"	260	175	60.6	202.5	45	112.89 76.35	295	8-M20 12-M24	115	88.9	4-14.3	22.1	329	18.2
250	10"	292	203	65.6	250.5	45	90.59 91.88	350 355	12-M20 12-M24	115	88.9	4-14.3	28.45	393	26.8
300	12"	337	242	76.9	301.6	45	103.52 106.12	400 410	12-M20 12-M24	140	107.95	4-14.3	31.6	462	40
350	14"	368	267	76.5	333.3	45	89.74 91.69	460 470	16-M20 16-M24	140	107.95	4-14.3	31.6	515	56
400	16"	400	309	86.5	389.6		51.2 72	515 525	16-M24 16-M27	197	158.75	4-20.6	33.15	579	96
450	18"	422	328	105.6	440.51		51.2 72	565 585	20-M24 20-M27	197	158.75	4-20.6	38	627	122
500	20"	480	361	131.8	491.6		64.2 82	620 650	20-M24 20-M30	197	158.75	4-20.6	41.15	696	202
600	24"	562	459	152	592.5		70.2 82	725 770	20-M27 20-M33	276	215.9	4-22.2	50.65	821	270

注Note:

DN50(2")~600(24") "LT" 型蝶阀分别适用于PN1.0/PN1.6MPa二种压力级, 表中每格有两个尺寸的分别表示PN1.0/PN1.6MPa二种压力级连接尺寸。与阀门连接的管法兰连接尺寸参照法兰连接尺寸表。蝶阀上法兰可通用于手动、蜗轮蜗杆传动、电动、气动等传动装置。

"LT" 型蝶阀的结构、性能、零件的材质与 "A" 型均相同, 区别在于 "A" 型可通过双头螺栓(或加长六角螺栓)对夹连接在两管法兰之间(即对夹式)。

"LT" 型除通过两普通六角螺栓连接在两管路之间外, 还可以安装在管端(即单夹式)作为排空阀使用, 但需在订货合同中注明管端使用。

DN50(2")~600(24")Type"LT" butterfly valve are suitable for the pressure grades of PN1.0MPa and PN1.6MPa separately Two dimensions in one column how two connection dimensions of PN1.0/PN 1.6MPa pressure grade for the connection dimensions of pipe flaligns mounted to the valve. Please refer to the Connection Dimensions of flanges Table. The upper flanges of the butterfly valves accommodates all types of operators: manual, wormgeal, electric and pneumatic actuators.

Difference between Type "A" and "LT": Both Type "A" and "LT" have the same constmcdon andperformances and are made and of the some materials. The main difference between them is that type "A" valves are mounted between pipe flanges (wafer type) by bolts(or extendcd hexagonbead bolts), while type "LT" can be either mounted between two pipes by ordinary hexagon head bolts or mourned n the pipe end (lugged-type). As the valves used at the end of pipe line, it is necessary to indicate in order.

以上两种形式由用户在订货合同中注明。

A bore two kinds of versions are given clear indication of by user in the order contFact.

法兰连接尺寸符合G4216, DIN2501, BS4504, BS10-E, JISB2220, AS2129, ANSI B16.1等标准, 须用户在合同中注明。

The flange links the size and fits the standards such as GB4216, DIN2501, BS4504, BS10-E, JISB2220, AS2129, ANSI B16.1 etc, and must give clear indication of in the contract user.

手柄传动装置外型尺寸及重量
Overall Dimensions & Weight of Manual Actuator

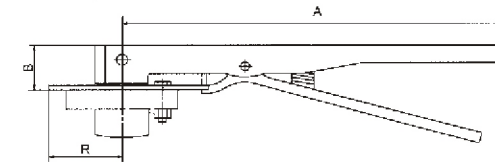

适用蝶阀口径(mm) Size mm	A	B	R	重量 Weight (kg)
50~100	266.7	32	51	0.5
125~150	345	32	51	0.8
200~300	353	45	76.5	1.3

蜗轮蜗杆传动装置外型尺寸及重量
Overall Dimensions & Weight of Wormgear Actuator

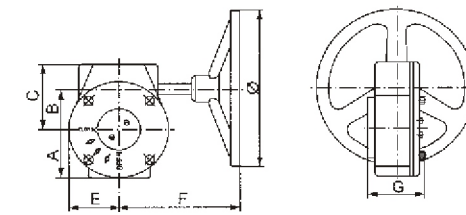

型号 Type	适用蝶阀口径 (mm) Size mm	A	B	C	E	F	G	重量 Weight (kg)
3D-15	50~150	52	45	74	52	152.5	75	5.2
3D-50	200~250	75	62.75	101	75	250	86	13
3D-120	300~350	81	80	118	81	227	83	15

蜗轮蜗杆二级传动装置外型尺寸及重量
Overall Dimensions & Weight of Double-stage Wormgear Actuator

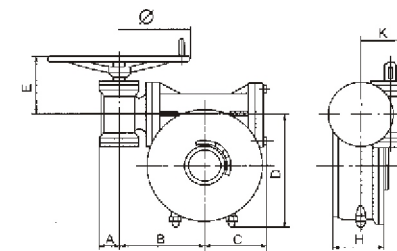

型号 Type	适用蝶阀口径 (mm) Size mm	A	B	C	D	E	φ	H	K	重量 Weight (kg)
3D-30/250	400~450	57	178	121	220	174	300	125	112	30
3D-30/400	500~600	57	221	142	274	174	300	145	112	72
3D-60/800	700~800	67	244	183	351	165	400	157	143	133

DN50~350蝶阀电动装置外型尺寸及重量
Performance Data, Overall Dimensions & Weight of Electric Actuator of Series "DN50~350"

型号 Type	LQ5-1	LQ10-1	LQ20-1	LQ40-1	LQ80-1
适用蝶阀口径mm Apply to the butterfly valve caliber(mm)	50~80	100	125~150	200	250~300
最大输出转矩N.m The maximum exports revolution regulation N.m	50	100	200	400	800
输出转速 r/min Export rotation rate r/min	1	1	1	1	1
电机功率kw Electric motor power kw	0.016	0.025	0.06	0.09	0.18
90° 启闭时间t 90° Start and stop time t	15	15	15	15	15
A	258	258	258	325	325
B	109	109	109	163	163
C	76	76	76	110	110
D	162	162	162	235	235
E	80	80	80	100	100
F	125	125	125	165	165
G	187	187	187	205	205
d	185	185	185	280	280
重量Weight(kg)	15	15	15	35	35

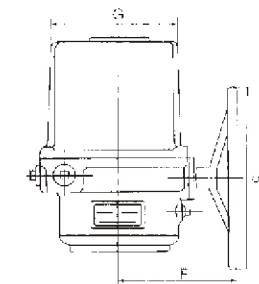
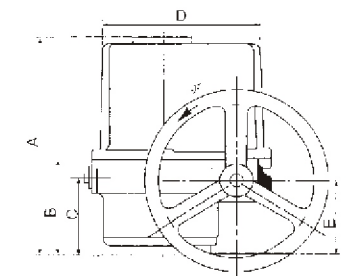

型号 Type	LQ5-1	LQ10-1	LQ20-1	LQ40-1	LQ80-1
适用蝶阀规格 Size mm (inch)	50(2")~80(3")	100(4")	125(5")~150(6")	200(8")	250(10")~300(12")
最大输出转矩(N.m)Max.Output Torque	50	100	200	400	800
输出转速(r/min)Output Speed	1	1	1	1	1
电机功率(W) Motor power	16	16	60	90	18
90° 启闭时间(S) Time for 90° Turning	15	15	15	15	15
A	258	258	258	325	325
B	143	143	143	171	171
C	68	68	68	100	100
D	162	162	162	235	235
E	80	80	80	100	100
F	125	125	125	165	165
G	187	187	187	205	205
d	185	185	185	280	280
重量 Weight (kg)	17	17	17	35	35

802系列电动装置性能参数外型尺寸及重量
Performance Data, Overall Dimensions & Weight of Series 802 Electric Actuator

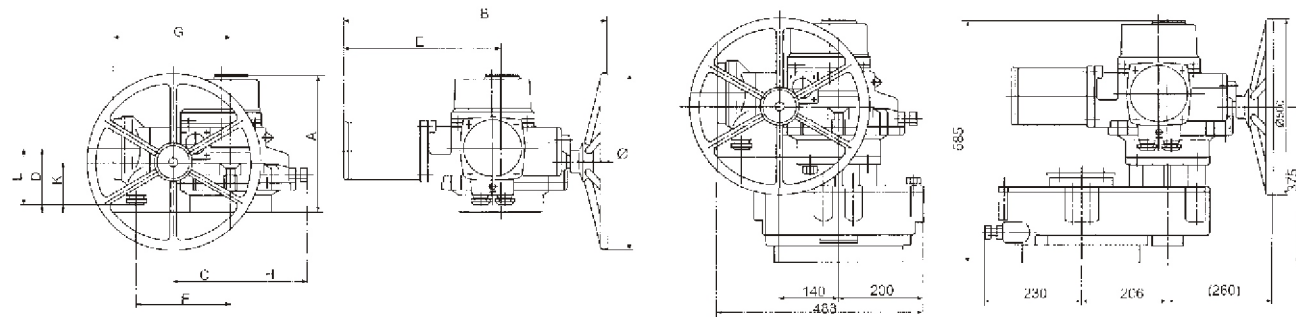

型号 Type	适用蝶阀规格 Size mm (inch)		最大输出转矩(N.m) Max. Output Torque	输出转速(r/min) Output Speed	电机功率(W) Motor power	90° 旋转时间 Time for 90° Turning	A	B	C	D	E	F	G	H	L	K	φ	重量 Weight (kg)
	PN1.0	PN1.6																
802.10-1	50(2")~100(4")	50(2")~100(4")	100	1	25	15	250	420	79	82	253	156	213	110	132	62	220	22
801.20-1	125(5")~150(6")	125(5")~150(6")	200	1	45	15	287	552	110	101	330	196	254	156	134	86	360	42
802.60-1	200(8")~300(12")	200(8")~250(10")	600	1	180	15	330	625	140	152	365	230	288	185	134	120	500	90
802.150-0.5	350(14")~450(18")	300(12")~350(14")	1500	0.5	370	30	具体尺寸请看802.1000-0.2外型图 The dimensions refer to 802.1000-0.2 outline sketch.											
802.250-1	50(20")	400(16")~450(18")	2500	1	750	15	具体尺寸请看802.1000-0.2外型图 The dimensions refer to 802.1000-0.2 outline sketch.											
802.500-0.5	600(24")	500(20")~600(24")	5000	0.5	750	30	具体尺寸请看802.1000-0.2外型图 The dimensions refer to 802.1000-0.2 outline sketch.											
802.1000-0.2	700(28")~800(32")	700(28")~800(32")	10000	0.2	1100	75	具体尺寸请看802.1000-0.2外型图 The dimensions refer to 802.1000-0.2 outline sketch.											

802、“LQ”系列电动装置控制器外形尺寸
Sketch Of Electric System Controller of Series 802、“LQ”

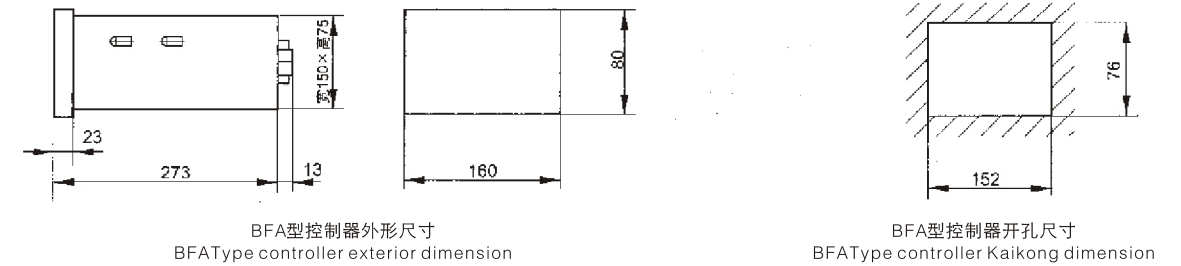

802、“LQ”系列电动装置电气原理图
Sketch of Electric System of Series 802、“LQ”

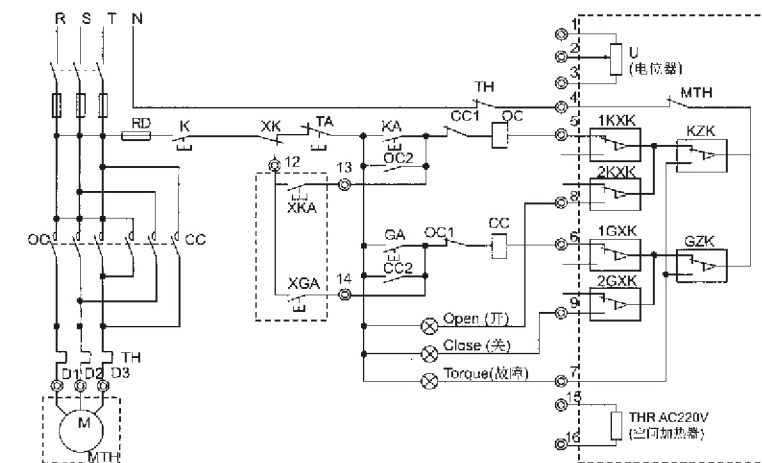

- 注:
- 图中虚线框中的元件在主机上。
 - KXK、GXK分别为开向、关向的行程限位开关，KZK、GZK分别为开向、关向的转矩开关。
 - XKA、XGA分别为现场开向、关向的点动按钮(该按钮为用户选购的附件)。
- Notes:
- Pursue component in being hit by the dotted line frame on the lead plane
 - The route or distance of travel that KXK, GXK face respectively for coming untied to the pass, is pesillon-limit The switch, KZK, GZK are to come untied to the pass switch to revolution regmlation respectively.
 - The person scen opens XKA, XGA respectveiy moving to the point that the pass faces, Button(owe a button the a cecessories being that the consumer picks out and buys).

Z60-3D1500电动装置性能参数外型尺寸及重量
Electric Z60-3D1500 device function parameter exterior dimension and weigh

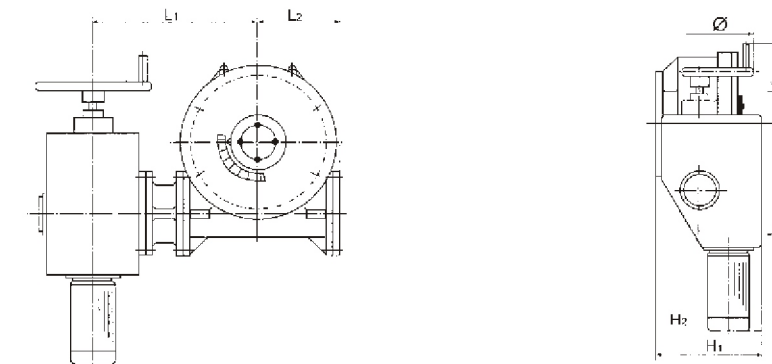

注: Z60-D1500型传动装置仅适于户内适用, 不具备户外及防爆功能。
Note: The Z60-3D1500 type actuator is suitable for indoor usage only, does not have the function preventing explosion outdoors.

型号 Type	适用蝶阀规格 mm (inch) Apply to the butterfly valve caliber mm (inch)	最大输出力矩 N.m The maximum exports revolution regulation N.m	输出转速 r/min Export rotation rate r/min	电机功率 kw Electric motor power kw	90° 旋转时间 Time for 90° Turning	L1	L2	L3	L4	H1	H2	φ	重量 Weight (kg)
ZA60-3D1500	900(36")~1000(40")	15000	0.8	1100	12	354	193	394	467	408	138	305	254

Z60-3D1500电动装置控制器外形尺寸
Sketch Of Electric System Controller of Series Z60-3D1500

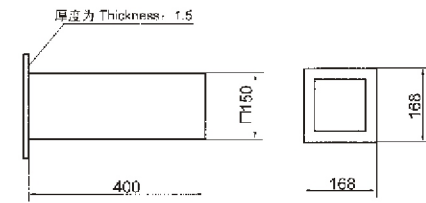

DFK型控制器外形尺寸
BFK Type controller exterior dimension

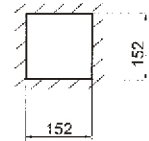

DFK型控制器开孔尺寸
BFK Type controller Kaikong dimension

Z60-3D1500电动装置电气原理图
Sketch Of Electric System of Series Z60-3D1500

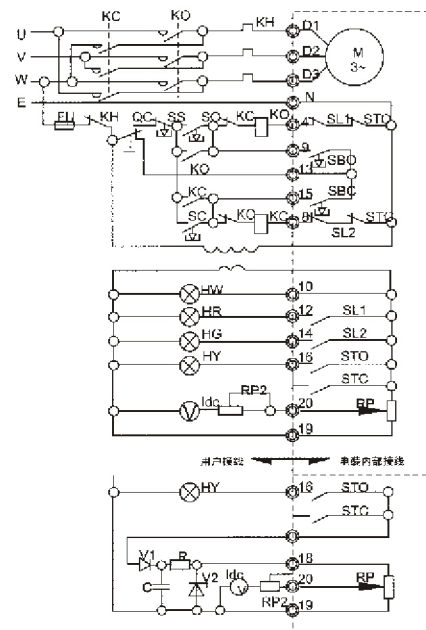

注:

- 1、双点划线内各元件均在主机内。
- 2、图示为阀门在开、关之间位置，开关QC在现场位置。
- 3、STO、STC正常工作时是受压状态。
- 4、图下部分为稳压系统，用户如采用，订货时请说明。

Note:

1. Within two chain line, every component is in the lead plane inner without exception.
2. Picture is shown for the valve between coming untied, closing location, switch QC is in scene position.
3. STO, STC are to accept pressure stste time regular job.
4. The lower part of picture is stabilivolt if system, consumer adopt explainaion, inviting when ordering goods.

SMC/HBC 电动装置性能参数外形尺寸及重量
Electric SMC/HBC device function parameter exterior dimension and weigh

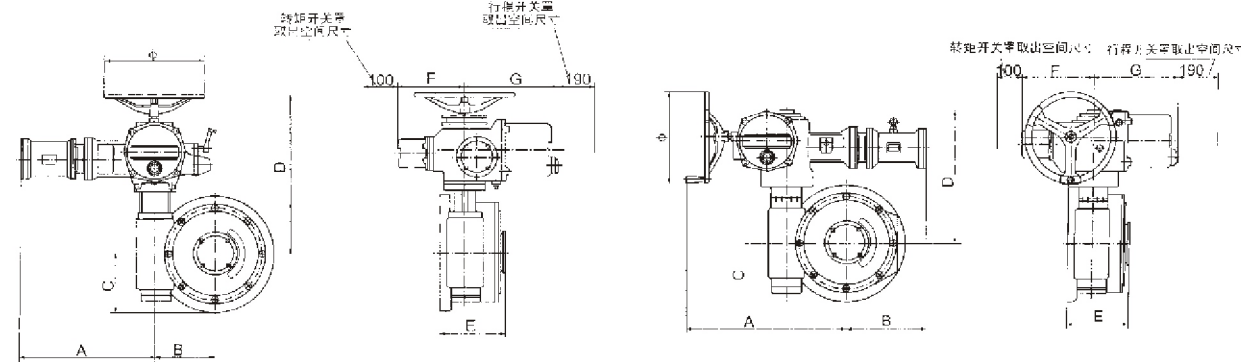

SMC-03/HBC
SMC-04/HBC

SMC-00/HBC
SMC-0/HBC

型号 Type	适用蝶阀规格 Size mm (inch)		最大输出力矩Nm The maximum exports revolution regulation N.m	输出转速 (r/min) Export rotation rate r/min	电机功率 (W) Electric motor power kw	90° 旋转时间 (s) Time for 90° Turning	A	B	C	D	E	F	G	φ	H*	重量 Weight (kg)
	PN1.0MPa	PN1.6MPa														
SMC-04/H0BC	200(8")-250(10")	200(8")-250(10")	580	0.5	300	30	243	64	121	422	160	185	328	508	90	74
SMC-03/H1BC	300(12")-450(16")	300(12")-450(16")	1760	0.5	600	30	470	89	145	491	188	202	369	508	35	120
SMC-03/H2BC	500(20")-600(24")	500(20")	2990	0.5	600	30	470	108	172	504	202	202	369	508	45	140
SMC-00/H3BC	700(28")-800(32")	600(24")	7650	0.5	1100	30	552	408	203	497	230	251	364	305	45	220
SMC-0/H4BC	900(36")-1000(40")	700(28")-800(32")	17300	0.4	1500	37.5	667	373	238	568	262	273	369	305	45	300

注: SMC/HBC 电动装置可用于户外, 并有防爆型, 控制器型号为LFK型。*H: SMC/HBC 电动装置与对夹式蝶阀连接用接盘高度。
Note: The electric device of SMC/HBC may be used to have the type preventing explosion together outdoors, the controller type is a LFK type.
*H: Electric device of SMC/HBC and the altitude linking up to gripping the dyadic butterfly gate with receiving a set.

SMC/HBC 电动装置控制器外型尺寸及端子接线图
SMC/HBC electrically operated installment controller outlook size and Termial wiring diagram

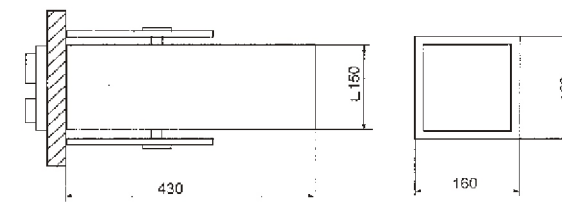

LFK 型控制器外型尺寸
LFK type controller exterior dimension

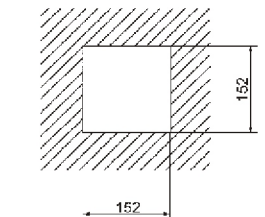

LFK 型控制器开孔尺寸
LFK type controller Kaikong dimension

D3	D2	D1				N	C	B	A
1	2	3	4	5	6	7	8	9	10
11	12	13	14	15	16	17	18	19	20
	23	22	21	6A	2A	8B	8A	4B	4A

控制器端子接线图
In chart in dashed line frame part on main engine.

SMC/HBC 电动装置电器原理图
Electric SMC/HBC device electrical equipment principle picture

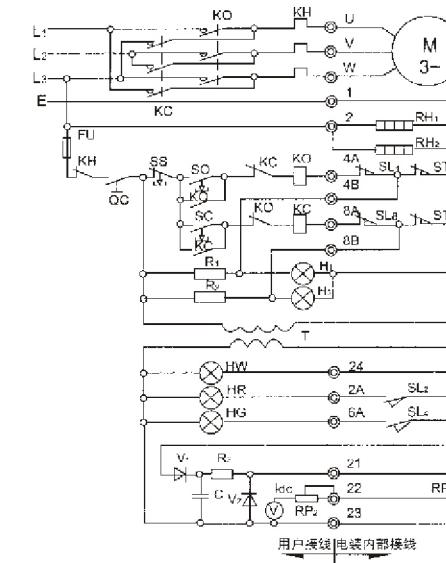

"A"、"LT"型对夹式蝶阀安装图
Installation Drawing of Type "A"、"LT" Wafer Butterfly Valves

注 Note:

1. 法兰连接尺寸符合 GB4216.4-4216.5-84 的规定，同时符合的国外法兰标准 见图二及对照表。
2. 管子外径尺寸"d0"符合 GB8163-87《热轧无缝钢管标准》，DN700(28") ~1000(40")大口径钢管外径尺寸由设计者自定。
3. 图中尺寸T为橡胶阀座凸出阀体端面作为法兰密封垫的厚度尺寸。
4. 用户自配法兰时，内凸圆直径D4应按样本提供的尺寸执行。

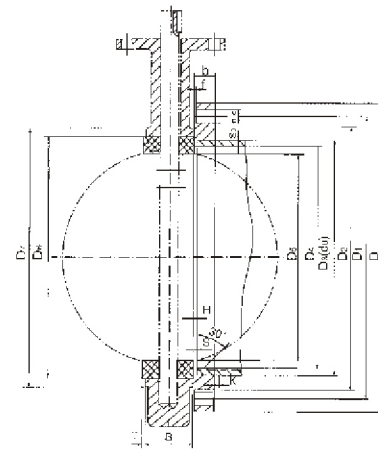

1. Mounting dimensions of the flanges are designed in accordance with GB4216.4421.65-84 and in accordance with foreign flange standards (see Fig.2.and Comprison table).
2. Outer diameters of pipes "d0"are in accordance with the standard GB88 1 63. 87 Hot. rolled Seamless Pipe. Tile outer diameter of largerpipes DN711(28")~1 000(40") is specified by designers.
3. The dimension "T" in the figure is the thickness of the rubber seat projecting from valve bodies to serve as the flange sealing face.
4. As the flange is made by userself, the diameter D4 should be in accordance with the size provided in this catalogue.

安装阀门用螺栓规格数量 Size & Quantity of Bolts Valve Installation

"A"型蝶阀螺栓连接图
Bolt Connection of Type "A" Butterfly Valve

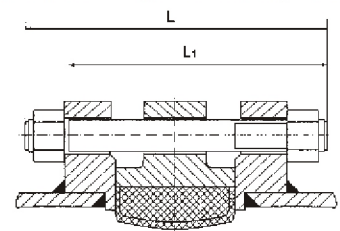

"LT"型蝶阀螺栓连接图
Bolt Connection of Type "LT" Butterfly Valve

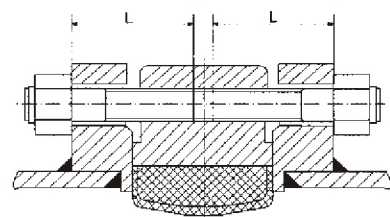

公称通径 Nominal diameter DN	1.0MPa				1.6MPa					
	双头螺栓 (适用 "A" 型蝶阀) Stud Bolt (for Type A Valve)		六角螺栓 (适用 "LT" 型蝶阀) Stud Bolt (for Type LT Valve)		双头螺栓 (适用 "A" 型蝶阀) Stud Bolt (for Type A Valve)		六角螺栓 (适用 "LT" 型蝶阀) Stud Bolt (for Type LT Valve)			
(mm) (inch)	数量 Qty	直径 x L1 Dia x L1	总长L Length	数量 Qty	直径 x L1 Dia x L1	数量 Qty	直径 x L1 Dia x L1	总长L Length	数量 Qty	直径 x L1 Dia x L1
50 2"	4	M16-110	130	4 x 2	M16-40	4	M16-110	130	4 x 2	M16-40
65 2.5"	4	M16-120	140	4 x 2	M16-45	4	M16-120	140	4 x 2	M16-45
80 3"	8	M16-120	140	8 x 2	M16-45	8	M16-120	140	8 x 2	M16-45
100 4"	8	M16-120	150	8 x 2	M16-50	8	M16-120	150	8 x 2	M16-50
125 5"	8	M16-130	150	8 x 2	M16-50	8	M16-130	150	8 x 2	M16-50
150 6"	8	M16-140	165	8 x 2	M16-50	8	M16-140	165	8 x 2	M20-50
200 8"	8	M20-150	175	8 x 2	M20-55	8	M20-150	175	12 x 2	M20-55
250 10"	12	M20-160	185	12 x 2	M20-60	12	M24-160	185	12 x 2	M24-60
300 12"	12	M20-170	195	12 x 2	M20-65	12	M24-170	200	12 x 2	M24-65
350 14"	16	M20-170	195	16 x 2	M20-65	16	M24-170	200	16 x 2	M24-65
400 16"	16	M24-190	220	16 x 2	M24-75	16	M27-190	230	16 x 2	M27-75
450 18"	20	M24-220	250	20 x 2	M24-80	20	M27-220	254	20 x 2	M27-80
500 20"	20	M24-260	290	20 x 2	M24-90	20	M30-260	294	20 x 2	M30-90
600 24"	20	M27-290	324	20 x 2	M27-100	20	M33-290	334	20 x 2	M33-100
700 26"	24	M27-300	334	-	-	20	M33-300	341	4 x 2	M33-99
800 32"	24	M30-300	364	-	-	24	M36-300	375	-	-
900 36"	24	M30-350	388	4 x 2	M30-100	-	-	-	-	-
1000 40"	24	M33-370	411	4 x 2	M33-100	-	-	-	-	-

1. 双头螺栓采用标准为GB898-88bm =1. 25d。
 2. 六角螺栓采用标准为GB5780-86。
 3. 900(36")、1000(40") PN1. 0MPa及 700(28")PN1.6MPa "A" 型阀体二 脖颈处采用六角螺栓连接，数量分 别为4 x 2，列于六角螺栓栏中。
- 1.The stud bolts are in accordance withGB 898-88 bm=1.25d.
2.The hexagon head bolts are in accordance with GB5780-86
3.The hexagon head bolts are used at the two necks of 900(36"), 1000(40") PN1.0MPa and 700 (28") PN1.6MPa Type"A" valve body The quantity is 4 x 2 and jisted in the col- umn of hexagon-beaded bolt.

"A"型对夹式蝶阀各国法兰连接尺寸对照图表
Flange Dimensions of Type "A" Wafer Butterfly Valve Adopted in Different Countries

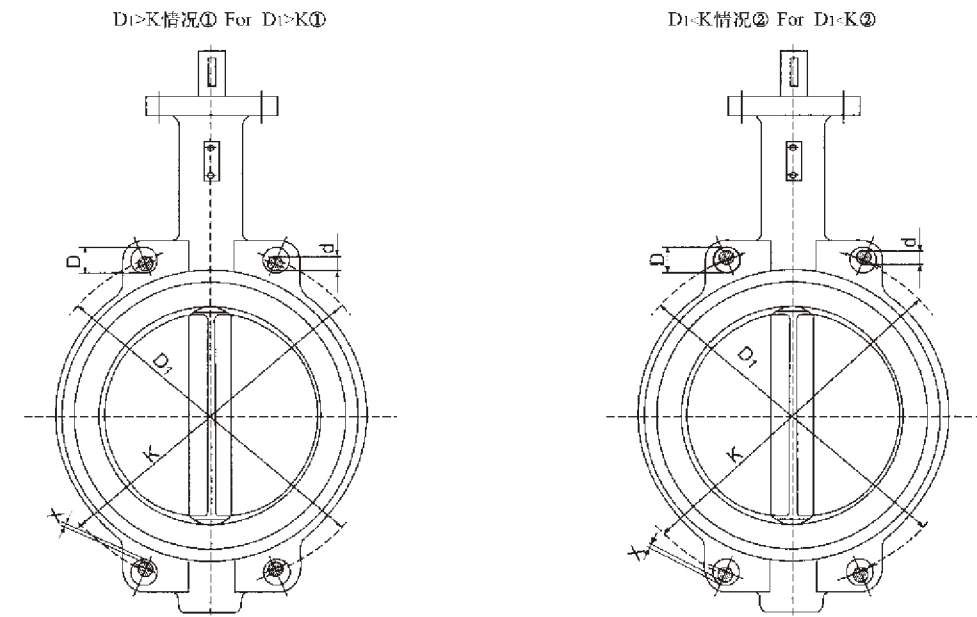

对照表 Comparison of Dimensions

规格 Size	D1	D	GB9112-88(国标)				DIN2501(德国) BS4504(英国) ISO2084 ISO2531 (国际标准)				BS10-E (英国)			ANS1125(美国)						
			d	x	k		d	x	k		d	x	k	d	x	k				
(mm) (inch)			MPa																	
			1.0	1.6	1.0	1.6	1.0	1.6	1.0	1.6	1.0	1.6	1.0	1.6	1.0	1.6				
50 2"	120	23	16	1.0	125②	16	1.0	125②	15.9	0.7	114.3	15.9	3.25	120.6②						
65 2.5"	136.2	26.5	16	0.85	145②	16	0.85	145②	15.9	0.7	127	15.9	3.55	139.7②						
80 3"	160	18	16	1.0	160②	16	1.0	160②	-	-	-	-	-	-						
100 4"	185	24.5	16	1.75	180②	16	1.75	180	15.9	0.7	177.8	15.9	1.55	190.5②						
125 5"	215	23	16	1.0	210②	16	1.0	210	15.9	0.83	209.58	19	1.55	215.9②						
150 6"	238	25	20	1.5	240②	20	1.5	240②	19	1.48	234.95	19	1.35	241.3②						
200 8"	295	25	20	2.5	295	20	2.5	295	19	1.55	292.1	19	1.3	298.4②						
250 10"	357	29	20	24	1.0	1.5	350	355②	20	24	1.0	1.5	350	355	19	4.3	355.6	22.2	0.95	361.9②
300 12"	407	29	20	24	1.0	1.0	400	410②	20	24	1.0	1.0	400	410	22.2	1.6	406.4	-	-	-
350 14"	467	30	20	24	1.5	1.5	460	470②	20	24	1.5	1.5	460	470	-	-	-	-	-	-

- 注：1. 规格尺寸为阀门通径尺寸；D1为阀门法兰孔中心分布圆尺寸；D为法兰孔直径。
2. 各国法兰标准中的d代表螺栓直径；X代表孔与螺栓的最小间隙；K代表标准法兰孔中心分布圆尺寸。
*如果需要上表中国外标准法兰请在合同中注明。
- Note: 1. Size-Nominal diameter of the valve; D1-Diameter of the flange bolt hole center circle; D-Diameter of the flange bolt holes.
2. d-Diameter of bolts; X-Minimmm clearance between the bolt and the bolt hole; K-Diameter of the bolt hole circle of standard flanges.
*Please give clear declaration in your contract when ordering flanges to foreign standard.

D341X-10/16

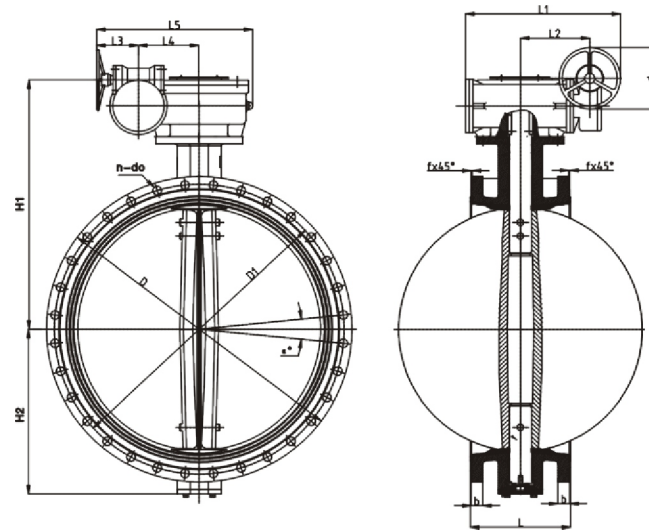

简介 Brief

本蝶阀系我公司最新研制的法兰蝶阀，主要适用于水厂、电厂、钢厂冶炼、造纸、化工、饮食等系统给排水用、尤为适用自来水管路上作为调节流量设备使用。

This butterfly valve is the flange butterfly valve that my company develops most newly, apply to water works, electric power plant, steel mill mainly smelt, paper making, system such as chemical industry, food and drink is for draining off's using, especially is put into use on the way as the equipment adjusting rate of flow by service pipe suitable for use.

外形尺寸及连接尺寸 Overall & Connection Dimensions

公称通径 Nominal diameter DN	L	1.0MPa			1.6MPa		
		D	D1	n-do	D	D1	n-do
50	108	165	125	4-18	165	125	4-18
65	112	185	145	4-18	185	145	4-18
80	114	200	160	8-18	200	160	8-18
100	127	220	180	8-18	220	180	8-18
125	140	250	210	8-18	250	210	8-18
150	140	285	240	8-22	285	240	8-22
200	152	340	295	8-22	340	295	12-22
250	165	395	350	12-22	405	355	12-26
300	178	445	400	12-22	460	411	12-26
350	190	505	460	16-22	520	470	16-26
400	216	565	515	16-26	580	525	16-30
450	222	615	565	20-26	640	585	20-30
500	229	670	620	20-26	710	650	20-33
600	267	780	725	20-30	840	770	24-36
700	292	895	840	24-30	910	840	24-36
800	318	1015	950	24-33	1025	950	24-39

D341X-10/16

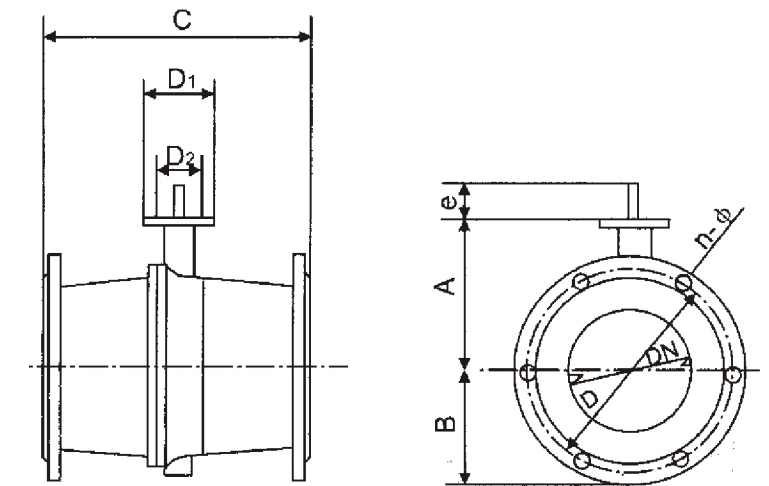

简介 Brief

法兰蝶阀是为用户替代传统闸阀而专门设计的。它集橡胶软密封对夹式蝶阀之优点，同时又兼顾闸阀之连接尺寸要求，使用户即选到高密封性能的蝶阀又满足替代不同标准的传统闸阀之尺寸要求。

The flange butterfly valve is to design that specially in order to marry consumer replacing the tradition valve. its collection rubber is soft merit of sealing up completely to gripping the dyadic butterfly gate, both gives consideration to the request linking a dimension of valve, makes a consumer be to select and use the butterflyvalve sealing off a function's to height and satisfies the request replacing dimension of being unlike the standard tradition valve at the same time.

性能规范 Technical Data

公称通径DN(mm) Nominal Diameter	50~600	50~600
公称压力PN(MPa) Nominal Pressure	1.0	1.6
试验压力 Testing Pressure	壳体 Shell	1.5
	密封 Sealing	1.1
介质温度 Working Temperatur	10°C~+150°C	10°C~+150°C
适用介质 Suitable Mediums	水、气、食品、油类 Water, gas, food, oil etc	

外形尺寸、连接尺寸和重量
Overall & Connection Dimensions & Weight

公称通径 Nominal diameter DN	A	B	C	D	D1	D2	E	n-φ	重量 Weight (kg)
50	144	79	180	125	77	57	32	4-18	10
80	144	89	210	160	77	57	32	8-18	18
100	170	110	230	180	92	70	32	8-18	24
150	226	138	280	240	92	70	32	8-22	41
200	260	170	330	295	115	89	45	8-22	64
250	292	203	380	350	115	89	45	12-22	80
300	337	231	420	400	140	108	45	12-22	117
350	368	260	450	460	140	108	45	16-26	200
400	400	290	480	515	197	159	51	16-26	215
500	480	355	540	620	197	159	64	20-26	300
600	562	400	600	725	276	215	76	20-30	

SD341X-10

简介 Brief

本蝶阀适用温度≤80℃、用于石油、化工、食品、医药、轻纺、造纸、电力、给排水、气体管路上，作调节流量和截流介质的作用。具有补偿管道热胀冷缩的功能。

This butterfly valve is suitable for temperature ≤80°C, is used on petroleum, chemical industry, foodstuff, medicine gently, the spinning and papermaking, power, plumbing and gas pipe route. and does the effect adjusted the volume of flow and dams a river the medium. Possess the bloated cold function that contracts of compensation pipeline heat.

特点 Features

- 1、设计新颖、合理、结构独特、重量轻、操作方便、起闭迅速。
 - 2、本伸缩蝶阀既能起到调节流量和截流作用，又能补偿管道温差，所产生的热胀冷缩功能，同时也便于安装和拆卸，为-阀多用产品。
- 1、The design is new and original and reasonable and the structure is unique and is light in weight and operates makes things convenient for and it is rapid case to close.
 - 2、This stretch butterfly valve can act to adjust the volume of flow with damming a river the effect to compensate that the pipeline difference in temperature is given rise to again hot expands to cool contracts the function and but also being easy to at the same time install and dismantle, use the product for one valve more.

安装注意事项 Installment matters needing attention

- 1、本蝶阀安装前必须清洗内腔杂物。
 - 2、本阀门可在一定范围内伸缩，安装前必须松开伸缩部位的密封垫压盖，然后代本阀门与管道所需要的长度后，再锁紧伸缩密封压盖。
- 1、This butterfly valve must rinse the cavity odds and ends before the installation
 - 2、These valve approve in the field flex hence fasten must loosen pars contractilis steric seal gland, then should telescopic joint regulate to required position keeper conduit bott post, anew keeper flex gland, these valve be incapable of exceed scope use up on.

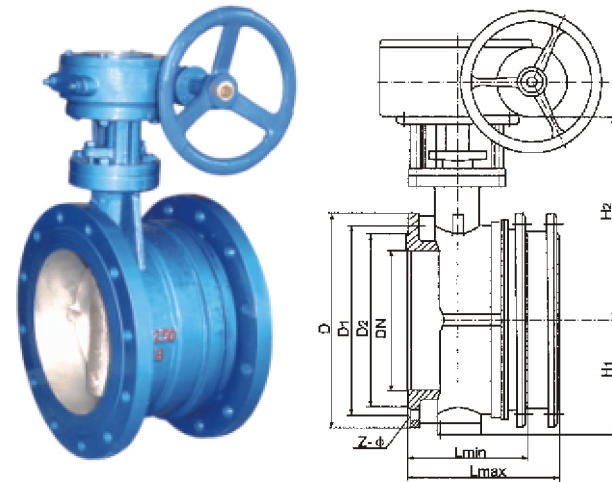

主要零部件材料 Material of Main Parts

名称 Name	材料 Material name
阀体 Valve body	铸铁、球墨铸铁、铸钢、不锈钢 Cast Iron, Nodular cast Iron, cast steel and stainless steel
阀板 Valve board	铸铁、球墨铸铁、铸钢、不锈钢 Nodular cast Iron, Coper alloy and stainless steel
阀杆 Valve pole	2Cr13、不锈钢衬 stainless steel line
密封圈 Sealing-circle	耐磨橡胶、丁腈橡胶等 The fine rubber of wear-resising rubber and NBR etc.
填料 Filler	丁腈橡胶V型垫、柔性石墨 Butadiene-acrylonitrile rubber V-mode pillow, expanded graphite

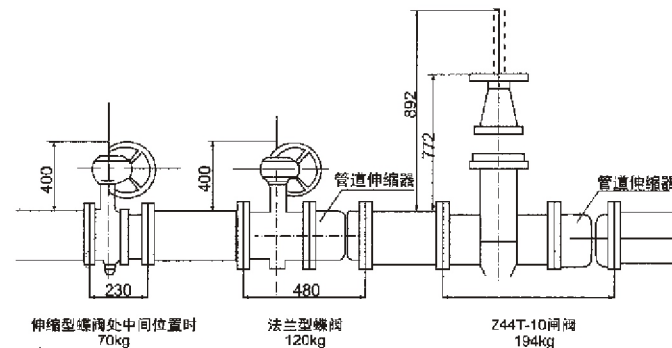

外形尺寸及连接尺寸
Overall & Connection Dimensions

压力 Pressure	直径 Diameter	最长 Longest L2	中间 Among L1	最短 Shortest L1	D2	D	D1	H	H1	H2	B1	B2	N	N2	φ	Z-φ
1.0 MPa	100	196	180	164	155	215	180	359	120	239	186	350	180	150	152	8-18
	150	227	210	192	210	280	210	392	124	278	186	350	180	150	152	8-23
	200	247	230	212	265	335	295	465	170	295	186	350	180	150	152	8-23
	250	267	250	230	320	390	350	555	198	357	253	453			250	12-23
	300	286	270	252	368	440	400	570	218	353	253	453			250	12-23
	350	310	290	270	428	500	460	670	253	427	253	415			250	16-23
	400	332	310	290	482	565	515		285	465	320	415	200	207	40	16-26
	450	352	330	310	532	615	565	800	310	490	320	415	200	207	400	20-26
	500	375	350	330	582	670	620	860	340	520	320		200	207	400	20-30
	600	420	390	360	635	780	725	1007	397	610		510			500	20-30
	700	465	430	395	800	895	840	1157	467	690	470	510			300	24-30
	800	510	470	430	905	1015	950	1295	530	765	470	510			300	24-34
	900	555	510	465	1005	1115	1050	1425	595	830	470	510			300	28-36
	1000	600	550	500	1110	1230	1160	1580	670	910	470	510			300	32-39
1200	690	630	570	1330	1455	1380	1815	785	1030	470				300	32-39	
1400	780	710	640	1560	1630	1560	2015	835	1180					600	36-36	
1600	860	790	750	1710	1830	1760		1100	1300					600	40-36	
1800	940	870	800	1920	2045	1970		1180	1400					600	44-39	
2000	1020	950	880	2125	2265	2100		1300	1580					600	48-42	
0.6 MPa																

简介 Brief

本蝶阀系我公司最新研制的软密封偏心法兰蝶阀。主要适用于水厂、电厂、钢厂冶炼、造纸、化工、饮食等系统供排水用，尤其适用于自来水管路上，作为调节和截流设备使用。

This butterfly valve is the flange butterfly valve that my company develops most newly, apply to water works, electric power plant, steel mill mainly smelt, paper making, system such as chemical industry, food and drink is for draining off's using, especially is put into use on the way as the equipment adjusting rate of flow by seryivepipe suitable for use.

特点 Features

- 1、结构简单紧凑，重量轻，90° 旋转，开关迅速。
 - 2、设计合理，装拆容易便于维修。
 - 3、采用偏心结构，减少密封圈的磨擦，延长阀门使用寿命。
 - 4、完全密封，泄漏为零。
 - 5、更换阀板密封圈、O型圈、蝶板、转轴等材质，可适用多种介质和不同温度。
- 1、Strudure simple compact, the weight is light 90° Revolves the switch is rapid.
 - 2、Designs reasonably, the assembling and dismantling is easy, to be advantageous for the service.
 - 3、Uses the eccentric structure, reduces the seal packing collar the friction, lengthens the valve service life.
 - 4、Completely seals, divulges for zero.
 - 5、Replacement valve board material quality and so on seal packing collar, O circle butterfly board, revolution axis, suitable many kinds of medium and different temperature.



标准与规范 Standard and standard

- 1、该产品符合GB12238 89《通用阀门法兰和对夹连接蝶阀》标准。
 - 2、试验符合GB/T13927-92《通用阀门压力试验》标准。
 - 3、侧法兰连接符合GB/T17241.6-1998《整体铸铁管法兰、GB4216.4-4216.5-84《灰铸铁管法兰及垫片》标准。同时分别符合BS4504, ISO2084、DIN2501中的PN1.0MPa, PN1.6MPa法兰连接标准。
- 1、This product conforms to GB12238-89 "General Valve Flange And to Clamps Connects Butterfly valve" the standard.
 - 2、The experiment conforms to GB/T "General Valve Pressure test"
 - 3、Measured the flange connection conforms to GB4216.4-4216.5-84 "Gray iron Flange And Filling piece" the standard.

主要零部件材料 Material of Main Parts

名称 Name	阀体 Valve body	阀板 Valve board	转轴 Fulcra	阀板密封圈 Valve plate lock ring	轴套 Shaft	阀体钢环 Valve body steel rung
国标 GB	QT500-7	QT500-7	2Cr13	ZCuZn38Mn3Pb2	丁腈橡胶 NBR	0Cr18Ni9
美标 ASTM	A126 ClassB	A536 65-45-12	420	B36	D2000 Aa6014	S32100
英标 BS	B145-20	BS278-65	Bs970	Bs1400	Bs2494 Buua-N	Bs321S12

性能规范 Technical Data

公称通径DN(mm) Nominal Diameter	100~1200	100~1200
公称压力PN(MPa) Nominal Pressure	1.0	1.6
试验压力 Testing Pressure	壳体 Shell	1.5
	密封 Sealing	1.1
介质温度 Working Temperatur	10°C~+120°C	
适用介质 Suitable Mediums	淡水、污水、空气等 Water, sewage etc. Gas	

100~400Dc34B3X-10Q 300~400DB34B3X-10Q

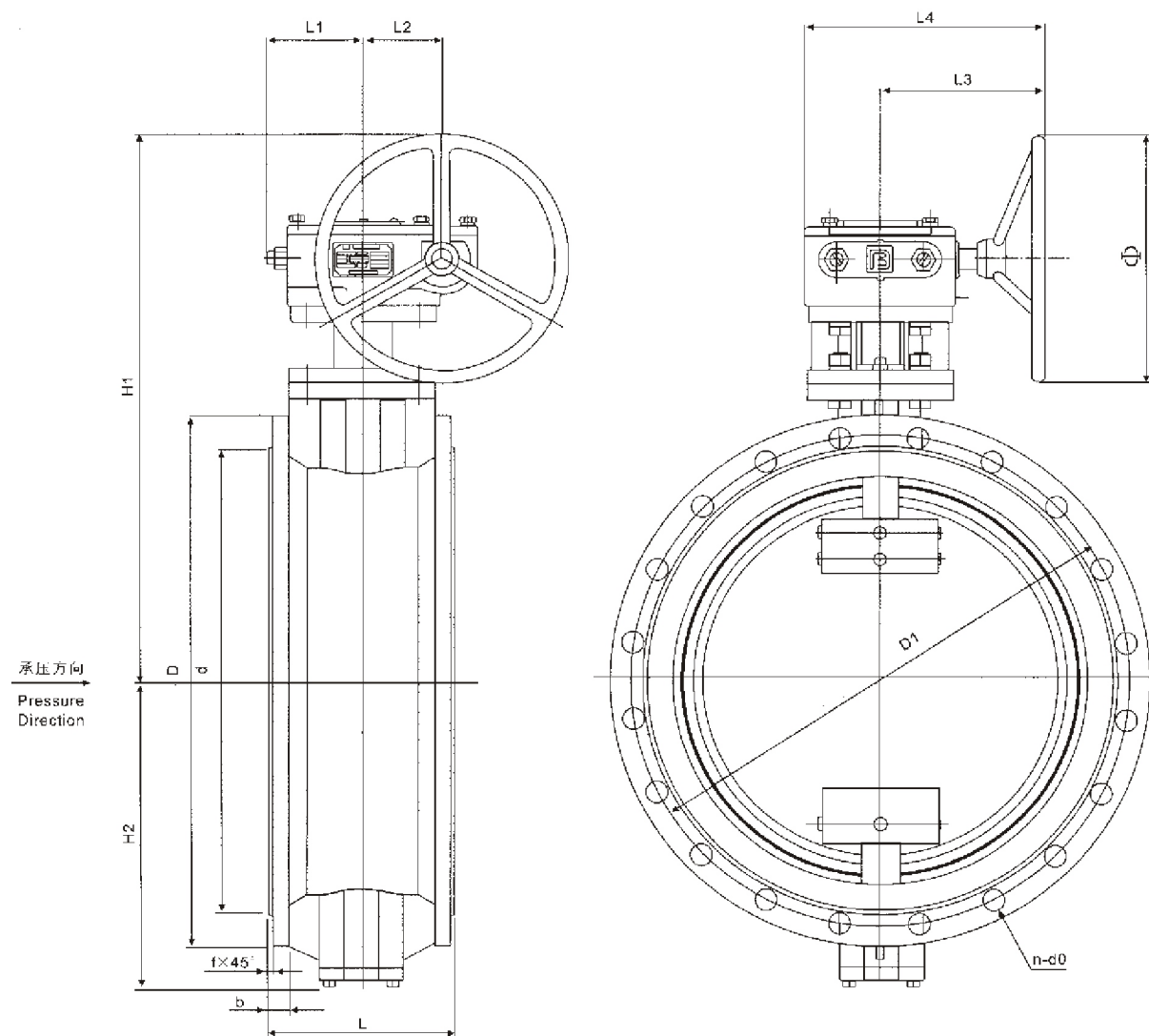

外形尺寸、连接尺寸和重量
Overall & Connection Dimensions & Weight

DN	传动装置 Gear Operator	L	D	D1	d	n	d0	b	f	H1	H2	L1	L2	L3	L4	φ	重量 Weight (kg)
100	XJ24	127	220	180	156	8	19	19	3	310	109	52	45	158	210	150	19
150	XJ24	140	285	240	211	8	23	19	3	440	143	52	45	158	210	150	37
200	XJ30	152	340	295	266	8	23	20	3	510	182	77	63	238	315	300	51
250	XJ30	165	395	350	319	12	23	22	3	565	219	77	63	238	315	300	68
300	4022	178	445	400	370	12	23	24.5	4	630	244	95	72	167	242	300	93
350	4023	190	505	460	429	16	23	24.5	4	715	283	110	91	188	275	400	122
400	4023	216	565	515	480	16	28	24.5	4	750	312	110	91	188	275	400	152

450~500Dc34B3X-10Q 450~500DB34B3X-10Q

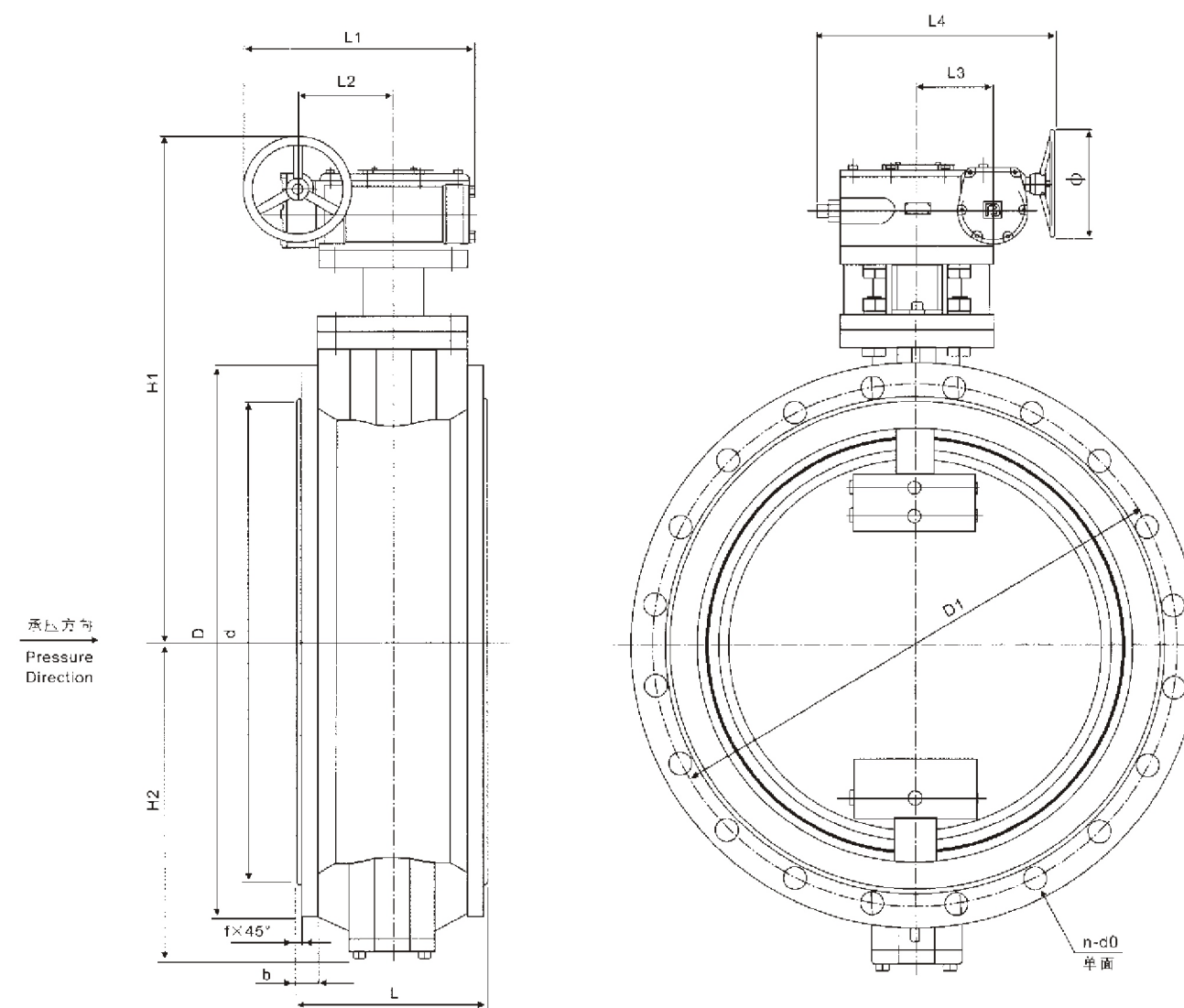

外形尺寸、连接尺寸和重量
Overall & Connection Dimensions & Weight

DN	传动装置 Gear Operator	L	D	D1	d	n	d0	b	f	H1	H2	L1	L2	L3	L4	φ	重量 Weight (kg)
450	4024	222	615	565	530	20	28	25.5	4	820	344	473	147	109	420	400	182
500	4024	229	670	620	582	20	28	26.5	4	845	381	473	147	109	420	400	230

600~1200Dc34B3X-10/6Q 600~1200DB34B3X-10/6Q

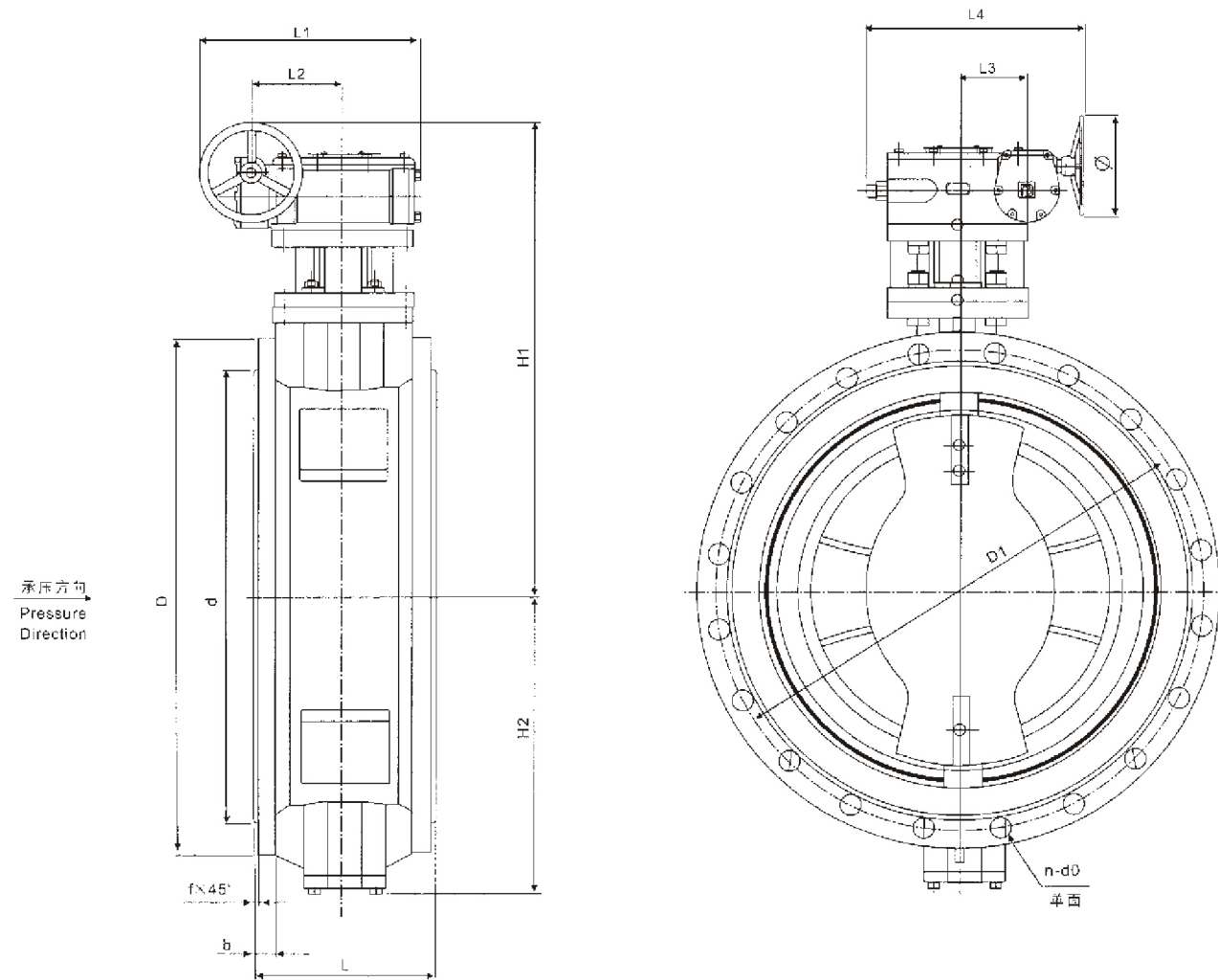

外形尺寸、连接尺寸和重量
Overall & Connection Dimensions & Weight

DN	传动装置 Gear Operator	L	D	D1	d	n	d0	b	f	H1	H2	L1	L2	L3	L4	φ	重量 Weight (kg)
600	4025	267	780/755	725/705	682/667	20	31/26	30	5	950	451	533	179	138	476	400	388
700	4025	292	895/860	840/810	794/772	24	31/26	32.5	5	1010	526	533	179	138	476	400	480
800	4026	318	1015/975	950/920	901/878	24	34/31	35	5	1140	581	655	217	170	577	500	661
900	4026	330	1115/1075	1050/1020	1001/978	28/24	34/31	37.5	5	1197	643	655	217	170	577	500	813
1000	4026	410	1230/1175	1160/1120	1112/1078	28	37/31	40	5	1277	722	655	217	170	577	500	1018
1200	4027	470	1455/1405	1380/1340	1328/1295	32	40/34	45	5	1511	840	748	262	202	664	500	1501

表中有两个数据，分别表示PN10/PN6两种不同压力级的尺寸。
Two dimensions in one column show different pressure grades of PN10 and PN6.

1400~2600Dc34B2X-10Q 1400~2600DB34B2X-10Q

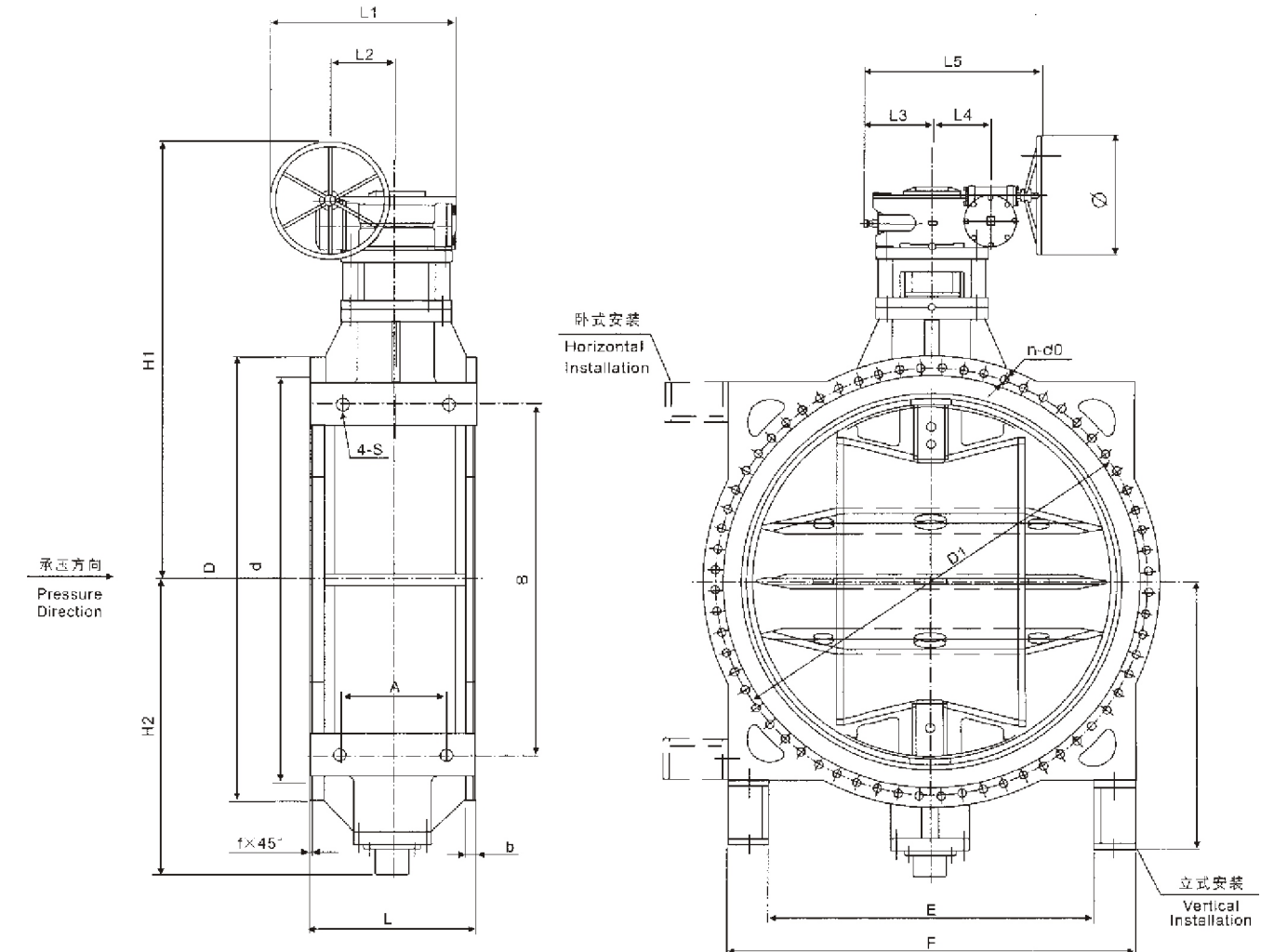

外形尺寸、连接尺寸和重量
Overall & Connection Dimensions & Weight

DN	传动装置 Gear Operator	D	D1	d	b	f	n-d0	L	H1	H2	L1	L2	L3	L4	L5	φ	A	4-s	B	E	F	h	重量 Weight (kg)
1400	4028	1675	1590	1530	46	5	36-43	530	1750	1150	884	334	305	238	790	500	310	33	1500	1360	1590	960	2895
1600	4028	1915	1820	1750	49	5	40-49	600	1870	1305	884	334	305	238	790	500	340	33	1600	1460	1700	1050	3655
1800	4028.5	2115	2020	1950	52	5	44-49	670	2125	1425	977	357.5	323	281	855	600	450	36	1900	1740	1990	1200	5210
2000	4029	2325	2230	2150	55	5	48-48	760	2280	1580	1059	397.5	345	307.5	903	600	480	36	2000	1850	2100	1323	6721
2200	4029.5	2550	2440	2370	58	5	52-56	850	2520	1710	1222	436	437.5	365.5	1075	800	400	36	2030	1830	2150	1410	7658
2400	40210	2760	2650	2570	62	5	56-56	750	2760	1880	1303	476	480	410.5	1191	800	490	45	2310	2120	2460	1470	10350
2600	40211	2960	2850	2780	66	5	60-56	900	3120	2010	1744	605	612	521	2024	1000	650	45	2400	2210	2540	1650	13708

双偏心金属硬密封蝶阀
Double-eccentric metal-seat butterfly valve

简介 Brief

- 1、本产品适用介质范围宽。可用于水、蒸气、油品、空气煤气等介质。
- 2、本产品适用场合广，如食品、饮料、医药、石化、电厂、钢厂、工业环保水处理高层建筑给排水管路作启闭调节介质流量之用。
- 3、本产品适用温度宽，-20℃~+425℃。
- 4、工作压力大耐磨损使用寿命长。
- 5、密封可靠性好，具有自动定心作用泄漏量小。
- 6、本产品分为对夹式和法兰式两种连接形式。
- 7、F四氟密封适用≤160℃。

- 1、This product suitable the medium scope to be wide. For example: May use in medium and so on water, vapour, quality, air coal gas.
- 2、This product suitable situations is broad if food the drink the medicine petrifed the power plant the steel mill, the industry environmental protection water treatment the high-rise construction for the drain line open shut using of the control agent current capacity.
- 3、This product is suitable the temperature to be wide. If -20℃~+425℃.
- 4、Working pressure big the wearability the service life is long.
- 5、Seal reliability good has the self-centering function, Leakage amounts is small.
- 6、This product divides into to clamps the type and the flange type two kind of connections forms.
- 7、The F four fluorine seals is suitable < =160℃.



D373H/F D343H/F

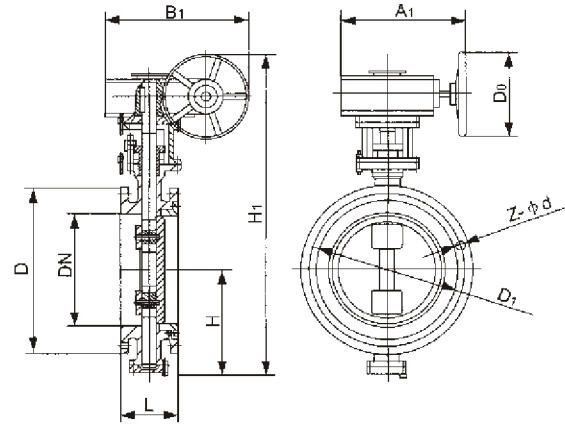

主要零部件材料 Material of Main Parts

名称 Name	材料 Material name
阀体 Valve body	球铁、铸钢、不锈钢 Nodular cast Iron, cast steel and stainless steel
阀板 Valve board	不锈钢、碳钢 Stainless steel, carbon steel
阀杆 Valve pole	不锈钢 Stainless steel
密封圈 Sealing-circle	不锈钢圈、聚四氟乙烯 Stainless steel, circless PTFE
填料 Filler	耐磨橡胶、聚四氟乙烯 Fluorine rubber and PTFE

性能规范 Technical Data

公称通径DN(mm) Nominal Diameter	10~1000		
公称压力PN(MPa) Nominal Pressure	1.0	1.6	2.5
试验压力 Testing Pressure	壳体 Shell	1.5	2.4
	密封 Sealing	1.1	1.76
介质温度 Working Temperatur	-20℃~+425℃		
适用介质 Suitable Mediums	液体或气体状腐蚀性介质 Liquid or gas shape corrosivity medium		

对夹蝶阀外形及连接尺寸 Overall & Connection Dimensions @ Weight Of Wafer Butterfly valve
D(3、6、9)43(H、F)-(16、25)C.P.R.V

公称通径 Nominal diameter DN	外形尺寸 Overall dimensions											连接尺寸 Connection dimensions			
	L	H	D373H			D673H			D973H			PN0.6MPa		PN1.0MPa	
			H1	A1	B1	H2	A2	B2	H3	A3	B3	D1	Z-φd	D1	Z-φd
50	43	112	350	180	200	625	245	72	530	250	255	110	4-14	125	4-18
65	46	115	370	180	200	625	245	72	550	250	255	130	4-14	145	4-18
80	49	120	380	180	200	645	245	72	565	250	255	150	4-14	160	8-18
100	56	138	420	180	200	675	355	92	600	250	255	170	4-18	180	8-18
125	64	164	460	180	200	715	355	92	640	250	255	200	8-18	210	8-18
150	70	175	555	270	280	800	355	92	705	300	315	225	8-18	240	8-22
200	71	208	605	270	280	850	250	170	775	300	315	280	8-18	295	8-22
250	76	243	680	270	280	925	250	170	945	300	315	335	12-18	350	12-22
300	83	283	800	380	420	1035	450	220	1070	300	315	395	12-22	400	12-22
350	92	310	835	380	420	1070	450	220	1140	300	315	445	12-22	460	16-22
400	102	340	915	450	470	1190	450	280	1210	300	315	495	16-22	515	16-22
450	114	380	960	480	490	1250	650	280	1335	575	714	550	16-22	615	20-26
500	127	410	1020	480	490	1295	650	280	1415	575	714	645	20-22	670	20-26
600	154	470	1225	480	490	1455	850	380	1605	656	810	755	20-26	780	20-30
700	165	550	1355	640	660	1585	850	380	1844	656	810	860	24-26	895	24-30
800	190	640	1470	640	660	1700	1250	380	2040	656	810	975	24-30	1015	24-33
900	203	710	1545	850	900	1865	1250	380	2255	785	863	1075	24-30	1115	28-33
1000	216	770	1795	850	900	2015	1500	580	2380	785	863	1175	28-30	1230	28-36
1200	254	890	1965	850	900	2226	1500	580	2640	785	863	1405	32-33	1455	32-39
1400	300	920	2380						2886			1630	36-33	1675	36-42
1600	530	1085	2956						3156			1820	40-33	1915	40-54
1800	670	1230	3221						3421			2045	44-42	2115	44-54
2000	760	1350	3485						3685			2265	48-48	2325	44-54

双偏心金属硬密封蝶阀
Double-eccentric metal-seat butterfly valve

对夹蝶阀外形及连接尺寸 Overall & Connection Dimensions @ Weight Of Wafer Butterfly valve
D(3、6、9)43(H、F)-(16、25)C.P.R.V

公称通径(DN) Nominal Diameter	外形尺寸 Overall dimensions											连接尺寸 Connection dimensions			
	L	H	373H			D673H			D973H			PN1.6MPa		PN2.5MPa	
			H1	A1	B1	H2	A2	B2	H3	A3	B3	D1	Z-φd	D1	Z-φd
50	43	112	350	180	200	605	245	72	530	250	255	125	4-18	125	4-18
65	46	115	370	180	200	625	245	72	550	250	255	145	4-18	145	8-18
80	49	120	380	180	200	645	355	72	565	250	255	160	8-18	160	8-18
100	56	138	420	180	200	675	355	92	600	250	255	180	8-18	190	8-22
125	64	164	460	180	200	715	355	92	640	250	255	210	8-18	220	8-26
150	70	175	555	270	280	800	355	92	705	300	315	240	8-22	250	8-26
200	71	208	605	270	280	850	250	170	775	300	315	295	12-22	310	12-26
250	76	243	680	270	280	925	250	170	945	300	315	355	12-22	370	12-30
300	83	283	825	380	420	1035	450	220	1070	300	315	410	12-26	430	16-30
350	92	310	900	380	420	1070	450	220	1140	300	315	470	16-26	490	16-33
400	102	340	980	450	470	1190	450	280	1210	300	315	525	16-30	550	16-36
450	114	380	1030	480	490	1250	650	280	1335	575	714	585	20-30	600	20-36
500	127	410	1105	480	490	1295	650	380	1415	575	714	650	20-33	660	20-36
600	154	470	1310	480	490	1455	850	380	1605	656	810	770	20-36	770	20-39
700	165	550	1435	640	660	1585	850	380	1844	656	810	840	24-36	875	24-42
800	190	640	1605	640	660	1700	1250	380	2040	656	810	950	24-39	990	24-48
900	203	710	1745	750	860	1865	1250	380	2255	785	863	1050	28-39	1090	28-48
1000	216	770	1885	850	900	2015	1250	380	2380	785	863	1170	28-42	1210	28-53
1200	254	890	2105	850	900		1250	380	2640	785	863	1390	32-48	1420	32-56

对夹蝶阀外形及连接尺寸 Overall & Connection Dimensions @ Weight Of Wafer Butterfly valve
D(3、6、9)43(H、F)-(16、10)C.P.R.V

公称通径(DN) Nominal Diameter	外形尺寸 Overall dimensions											连接尺寸 Connection dimensions					
	L	H	373H			D643H			D943H			PN1.6MPa		PN2.5MPa			
			H1	A1	B2	H2	A2	B2	H3	A3	B3	D	D1	Z-φd	D	D1	Z-φd
50	108	112	350	180	200	605	245	72	530	250	255	140	110	4-14	165	125	4-18
65	112	115	370	180	200	625	245	72	550	250	255	160	130	4-14	185	145	4-18
80	114	120	380	180	200	645	245	72	565	250	255	190	150	4-18	200	160	8-18
100	127	138	420	180	200	675	355	92	600	250	255	210	170	4-18	220	180	8-18
125	140	164	460	180	200	715	355	92	640	250	255	240	200	8-18	250	210	8-18
150	140	175	555	270	280	800	355	92	705	300	315	265	225	8-18	285	240	8-22
200	152	208	605	270	280	850	250	170	775	300	315	320	280	8-18	340	295	8-22
250	165	243	680	270	280	925	250	170	945	300	315	375	355	12-18	395	350	12-22
300	178	283	800	380	420	1035	450	220	1070	300	315	440	395	12-22	445	400	12-22
350	190	310	835	380	420	1070	450	220	1140	300	315	490	445	12-22	505	460	16-22
400	216	340	915	450	470	1190	450	280	1210	300	315	540	495	16-22	565	515	16-26
450	222	380	960	450	470	1250	650	280	1335	575	714	595	550	16-22	615	565	20-26
500	229	410	1020	480	490	1295	650	280	1415	575	714	645	600	20-22	670	620	20-26
600	267	470	1225	640	660	1455	850	380	1605	656	810	755	705	20-26	780	725	20-30
700	292	550	1355	640	660	1585	850	380	1844	656	810	860	810	24-26	895	840	24-30
800	318	640	1470	640	660	1700	1250	380	2040	656	810	975	920	24-30	1015	950	24-33
900	330	710	1545	850	900	1865	1250	380	2255	785	863	1075	1020	24-30	1115	1050	28-33
1000	410	770	1795	850	900	2015	1500	580	2380	785	863	1175	1120	28-30	1230	1160	28-36
1200	470	890	1965	850	900	2226	1500	580	2640	785	863	1405	1340	32-33	1455	1380	32-39
1400	530	920	2380						2886			1630	1560	36-33	1675	1590	36-42
1600	600	1085	2956						3156			1820	1760	40-33	1915	1820	40-54
1800	670	1230	3221						3421			2045	1970	44-42	2115	2020	44-54
2000	760	1350	3485						3685			2265	2180	48-48	2325	2230	44-54

对夹蝶阀外形及连接尺寸 Overall & Connection Dimensions @ Weight Of Wafer Butterfly valve
D(3、6、9)43(H、F)-(16、25)C.P.R.V

公称通径(DN) Nominal Diameter	外形尺寸 Overall dimensions											连接尺寸 Connection dimensions					
	L	H	373H			D643H			D943H			PN1.6MPa		PN2.5MPa			
			H1	A1	B1	H2	A2	B2	H3	A3	B3	D	D1	Z-φd	D	D1	Z-φd
50	108	112	350	180	200	605	245										

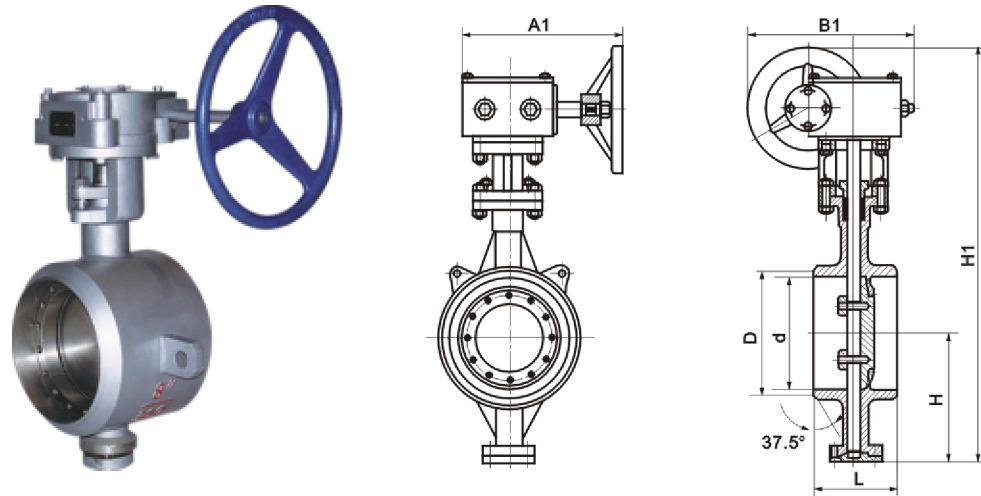

主要外形和连接尺寸 Main external and connection dimension

单位Unit: mm

公称压力Nominal pressure PN1.6MPa									
通径Diameter		外形尺寸 (参考值) External dimension(consult)							参考重量(kg) Consult weight
毫米mm	英寸inch	L	D	d	H	H1	A	B	
80	3	180	90	78	90	356	180	200	27
100	4	190	110	96	100	375	180	200	34
125	5	200	135	121	113	401	180	200	41
150	6	210	161	146	130	450	270	280	43
200	8	230	222	202	205	545	400	425	81
250	10	250	278	254	235	630	400	425	102
300	12	270	330	303	275	715	450	560	132
350	14	290	382	351	309	817	450	560	164
400	16	310	432	398	346	923	535	580	193
450	18	330	484	450	392	1059	535	580	238
500	20	350	535	501	427	1126	535	580	302

公称压力Nominal pressure PN1.6MPa									
通径Diameter		外形尺寸 (参考值) External dimension(consult)							参考重量(kg) Consult weight
毫米mm	英寸inch	L	D	d	H	H1	A	B	
600	24	390	636	602	509	1369	570	660	457
700	28	430	726	692	572	1492	750	550	810
800	32	470	826	792	638	1622	750	550	1093
900	36	510	926	892	700	1924	750	550	1410
1000	40	550	1028	992	765	2054	900	750	1870
1200	48	630	1228	1192	860	2259	1000	925	2082
1400	56	710	1428	1392	986	2610	1000	925	2850
1600	64	790	1628	1592	1106	2856	1000	925	4235
1800	72	870	1828	1792	1226	3121	1100	980	5346
2000	80	950	2028	1992	1345	3385	1100	980	7328

公称压力Nominal pressure PN2.5MPa									
通径Diameter		外形尺寸 (参考值) External dimension(consult)							参考重量(kg) Consult weight
毫米mm	英寸inch	L	D	d	H	H1	A	B	
80	3	180	90	78	90	356	180	200	38
100	4	190	110	96	106	387	180	200	40
125	5	200	135	121	122	413	180	200	60
150	6	210	161	146	136	459	270	280	65
200	8	230	222	202	215	585	400	425	85
250	10	250	278	254	247	649	400	425	135
300	12	270	330	303	288	771	450	560	175
350	14	290	382	351	333	929	450	560	195
400	16	310	432	398	359	993	535	580	295
450	18	330	484	450	405	1053	535	580	350
500	20	350	535	501	444	1245	535	580	510
600	24	390	636	602	521	1750	570	660	625
700	28	430	726	692	586	1519	750	550	925
800	32	470	826	792	659	1659	750	550	1260
900	36	510	926	892	720	1829	750	550	1790
1000	40	550	1028	992	780	1949	900	750	1940
1200	48	630	1228	1192	889	2243	1000	925	2810
1400	56	710	1428	1392	1000	2462	1000	925	3500

公称压力Nominal pressure PN4.0MPa									
通径Diameter		外形尺寸 (参考值) External dimension(consult)							参考重量(kg) Consult weight
毫米mm	英寸inch	L	D	d	H	H1	A	B	
80	3	180	90	78	108	430	180	200	39
100	4	190	110	96	108	392	180	200	50
125	5	200	135	120	120	414	180	200	75
150	6	210	161	145	135	494	270	280	100
200	8	230	222	200	202	578	400	425	135
250	10	250	278	252	235	673	400	425	190
300	12	270	330	301	280	793	450	560	240
350	14	290	382	351	315	921	450	560	320
400	16	310	432	398	355	1021	535	580	450
450	18	330	484	448	370	1143	535	580	500
500	20	350	535	495	420	1192	535	580	560
600	24	390	636	595	490	1327	570	660	720